

Only copies from the original of this topography map marked with an original of the Land Surveyors embossed seal or red colored seal shall be considered to be true, valid copies.

Unauthorized alteration or addition to a map bearing a licensed Land Surveyors seal is a violation of Section 7209, Subdivision 2 of the New York State Education Law.

Possession only where indicated.

Adjacent property lines and easements not surveyed or certified. Access to adjacent rights of way, easements and public or private lands not guaranteed or certified.

Underground utilities shown hereon are approximate and should be verified before excavating. Additional underground utilities are not shown or certified. Encroachments and structures below grade, if any, not shown or certified.

Subject to covenants, easements, restrictions, conditions and agreements of record.

This map is prepared to show topography only and is not to be used for title transfer purposes. Map may not be certified to title companies and/or banks.

Tree species shown hereon to be verified by a licensed arborist and are not certified by surveyor.

Elevations shown hereon generally in accordance with North American Vertical Datum 88.

Surveyed in accordance with Deed Liber 10592, Page 175.

Premises shown hereon designated on the Town of Greenburgh Tax Maps as: Section 3.170, Block 151, Lot 18.

Property Address: 253 Judson Ave
Dobbs Ferry, NY 10522

TOPOGRAPHY OF PROPERTY
PREPARED FOR
SHUMITA HANNA BASU
SITUATE IN THE
TOWN OF GREENBURGH
VILLAGE OF DOBBS FERRY
WESTCHESTER COUNTY, NEW YORK

SCALE: 1" = 20'

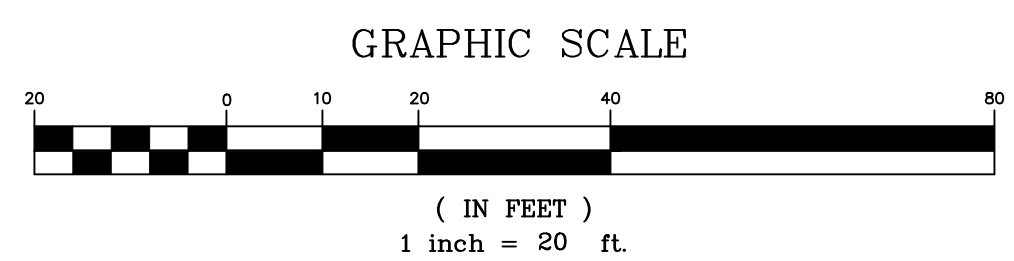

Surveyed: October 8, 2020
Map Prepared: October 9, 2020
Map Revised: December 1, 2020 to show certifications
Map Revised: December 24, 2020 Map Revised: June 2, 2021 to show trees
Map Revised: October 27, 2021

By: *Daniel T. Merritt*
New York State Licensed Land Surveyor No.050604

COPYRIGHT © 2020
TC MERRITTS LAND SURVEYORS
ALL RIGHTS RESERVED, UNAUTHORIZED DUPLICATION OR
ELECTRONIC TRANSMISSION WITHOUT PRIOR PERMISSION
IS A VIOLATION OF APPLICABLE LAWS.

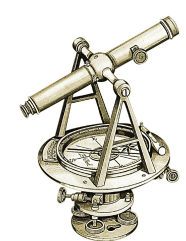

TC MERRITTS LAND SURVEYORS
394 BEDFORD ROAD • PLEASANTVILLE • NY 10570
(914) 769-8003 • (203) 622-8899

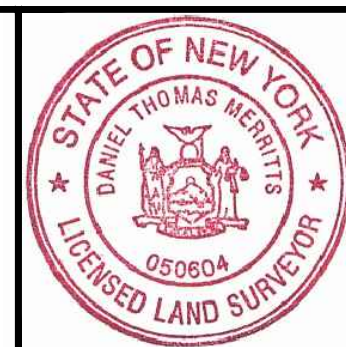

Project: 20-399	Field Survey By: BFC
Drawn By: BFC	Checked By: DM