

# SNAP-CLAD PANEL



**INDICATES SELECTED OPTIONS  
FOR THE FOSSNER RESIDENCE,  
7 FAIRLAWN AVE.**

## MATERIALS



.032 aluminum	24 gauge steel
.040 aluminum	22 gauge steel

## SPECS



10", 12", 16" or 18" O.C. 1-3/4" High

UL-90

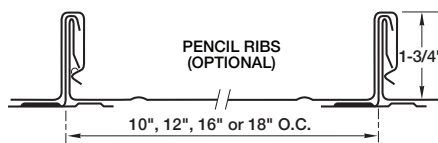
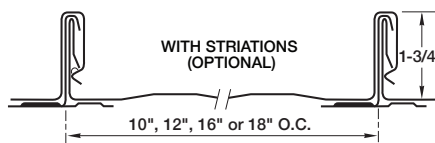
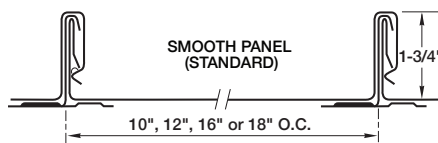
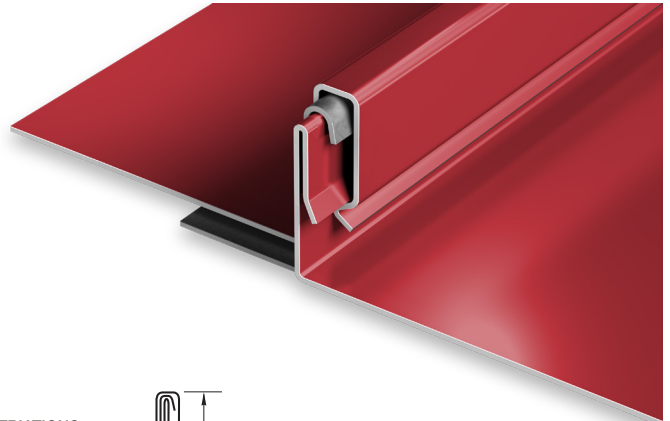

## PRODUCT FEATURES

- ▶ Architectural/structural panel
- ▶ Factory-applied sealant available
- ▶ Continuous interlock
- ▶ Labor-saving one-piece design
- ▶ Pencil ribs upon request
- ▶ Striations upon request
- ▶ Factory eave notching available
- ▶ 30-year-non-prorated finish warranty
- ▶ Maximum factory-produced panel length is 64' (check w/factory for longer lengths)
- ▶ Weathertightness warranty available



- ▶ 43 stocked colors (24 gauge steel)
- ▶ 16 Stocked colors (22 gauge steel)
- ▶ 36 stocked colors (.032 aluminum)
- ▶ 22 stocked colors (.040 aluminum)
- ▶ Panels available in Galvalume Plus

## UL CLASSIFICATION

- ▶ UL-580 Class 90 wind uplift
- ▶ UL-1897 wind uplift
- ▶ UL-790 Class A fire rated
- ▶ UL-263 fire resistance rated
- ▶ UL-2218 impact resistance rated

- ▶ UL-90 rated aluminum panel up to 16" O.C.
- ▶ UL-90 rated steel panel up to 18" O.C.

## ASTM TESTS

- ▶ ASTM E1592 tested
- ▶ ASTM E283/1680 tested
- ▶ ASTM E331/1646 tested

## FLORIDA BUILDING & MIAMI-DADE PRODUCT APPROVALS

Please refer to [pac-clad.com](http://pac-clad.com) or your local factory for specific product approval numbers for Snap-Clad.

Note: UL 90 is available on steel panels up to 18" on center, and on aluminum panels up to 16" on center.

# Standard Colors



**INDICATES SELECTED OPTIONS  
FOR THE FOSSNER RESIDENCE,  
7 FAIRLAWN AVE.**



▲ ★ PATINA GREEN



▲ ★ TEAL



▲ ★ HEMLOCK GREEN



FOREST GREEN



HARTFORD GREEN



▲ ★ EVERGREEN



▲ ★ HUNTER GREEN



▲ ★ ARCADIA GREEN



▲ ★ MILITARY BLUE



BERKSHIRE BLUE



▲ GRAPHITE



▲ ★ CHARCOAL



INTERSTATE BLUE



▲ ★ SLATE BLUE



AWARD BLUE



MATTE  
BLACK STEEL      BLACK  
ALUMINUM

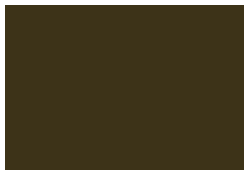

▲ ★ DARK BRONZE



▲ BURNISHED SLATE

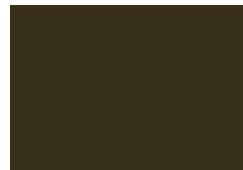

▲ AGED BRONZE



▲ ★ MEDIUM BRONZE



▲ ★ MANSARD BROWN



BURGUNDY



▲ ★ TERRA COTTA



▲ ★ CARDINAL RED



▲ ★ COLONIAL RED



MIDNIGHT BRONZE



▲ ★ MUSKET GRAY



▲ ★ SIERRA TAN

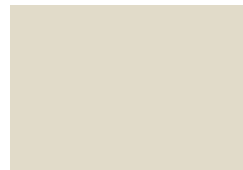

▲ ★ SANDSTONE

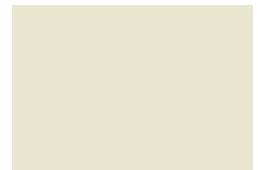

▲ ★ ALMOND



▲ ★ SLATE GRAY



▲ ★ CITYSCAPE



▲ ★ GRANITE

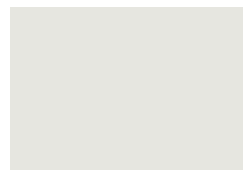

▲ ★ STONE WHITE

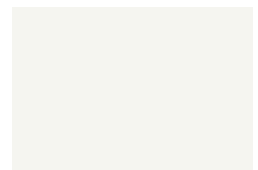

▲ ★ BONE WHITE



**PAC-CLAD®**

P E T E R S E N

A CARLISLE COMPANY

**PAC-CLAD.COM**

IL: 800 PAC CLAD    TX: 800 441 8661    MD: 800 344 1400  
AZ: 833 750 1935    GA: 800 272 4482    MN: 877 571 2025

# PAC-CLAD® Color Availability

PAC-CLAD STANDARD COLORS	REFLECTIVITY	EMISSIONITY	3 YEAR EXPOSURE	SRI	STEEL		ALUMINUM				20-IN. COIL		ENERGY STAR
					24 GA.	22 GA.	.032	.040	.050	.063	24 GA.	.032	
AGED BRONZE	0.29	0.87	0.27	29	✓								
ALMOND	0.56	0.86	0.55	65	✓	✓	✓	✓	✓		✓		★
ARCADIA GREEN	0.29	0.87	0.29	29	✓		✓						★
AWARD BLUE***	0.24	0.86	0.23	22	✓		✓		✓				
BERKSHIRE BLUE*	0.30	0.87	0.27	31	✓								
BLACK ALUMINUM**	0.04	0.89	0.04	-2			✓	✓	✓	✓			
BONE WHITE	0.70	0.86	0.69	85	✓	✓	✓	✓	✓	✓	✓	✓	★
BURGUNDY	0.14	0.85	0.13	9	✓		✓		✓				
BURNISHED SLATE	0.32	0.87	0.31	33	✓								
CARDINAL RED***	0.44	0.86	0.44	49	✓		✓		✓				★
CHARCOAL	0.30	0.86	0.30	30	✓		✓	✓	✓		✓	✓	★
CITYSCAPE	0.49	0.86	0.50	56	✓	✓	✓	✓	✓		✓	✓	★
COLONIAL RED	0.31	0.86	0.31	31	✓		✓	✓	✓				★
DARK BRONZE	0.29	0.86	0.29	29	✓	✓	✓	✓	✓	✓	✓	✓	★
EVERGREEN	0.28	0.86	0.26	27	✓		✓						★
FOREST GREEN	0.10	0.86	0.10	4	✓	✓	✓	✓	✓				
GRANITE*	0.33	0.87	0.33	34	✓	✓	✓	✓	✓				★
GRAPHITE	0.29	0.87	0.28	29	✓								
HARTFORD GREEN	0.08	0.88	0.08	3	✓		✓	✓	✓				
HEMLOCK GREEN	0.31	0.87	0.30	32	✓		✓		✓				★
HUNTER GREEN	0.28	0.86	0.27	27	✓		✓						★
INTERSTATE BLUE	0.16	0.87	0.15	12	✓		✓		✓				
MANSARD BROWN	0.31	0.86	0.31	31	✓	✓	✓	✓	✓				★
MATTE BLACK STEEL**	0.26	0.86	0.25	25	✓	✓					✓		
MEDIUM BRONZE	0.30	0.87	0.29	31	✓	✓	✓	✓	✓	✓	✓	✓	★
MIDNIGHT BRONZE	0.06	0.87	0.06	0	✓			✓					
MILITARY BLUE	0.31	0.86	0.30	31	✓		✓						★
MUSKET GRAY	0.32	0.86	0.31	33	✓	✓	✓		✓				★
PATINA GREEN	0.33	0.86	0.32	34	✓		✓						★
SANDSTONE	0.48	0.86	0.48	54	✓	✓	✓	✓	✓	✓	✓	✓	★
SIERRA TAN	0.32	0.82	0.31	31	✓	✓	✓	✓	✓		✓		★
SLATE BLUE	0.28	0.86	0.27	27	✓		✓						★
SLATE GRAY	0.38	0.86	0.37	41	✓	✓	✓	✓	✓		✓	✓	★
STONE WHITE	0.69	0.86	0.67	84	✓	✓	✓	✓	✓	✓	✓	✓	★
TEAL	0.32	0.86	0.32	33	✓		✓						★
TERRA COTTA	0.34	0.87	0.33	36	✓		✓		✓		✓	✓	★
PAC-CLAD PREMIUM COLORS													
AGED COPPER	0.55	0.80	0.53	62	✓		✓						★
ANODIC CLEAR	0.32	0.83	0.31	31				✓					
CHAMPAGNE	0.50	0.85	0.49	57	✓		✓	✓	✓				★
COPPER PENNY	0.52	0.81	0.52	58	✓		✓	✓	✓		✓		★
SILVER	0.47	0.87	0.46	53	✓	✓	✓	✓	✓		✓	✓	★
SILVERSMITH	0.32	0.88	0.32	34				✓					
WEATHERED COPPER	0.45	0.88	N/A	51	✓								
WEATHERED STEEL	0.32	0.89	N/A	34	✓								
WEATHERED ZINC	0.48	0.82	0.46	53	✓	✓	✓		✓				★
ZINC	0.42	0.82	0.38	45	✓		✓	✓	✓				★
CLEAR-COAT ACRYLIC FINISH (NON-KYNAR)													
GALVALUME PLUS	0.68	0.14	0.55	57	✓	✓					✓		★

PAC-CLAD Premium finishes are available from stock at a moderate extra cost. PAC-CLAD Copper Penny is a Non-Weathering finish. Solar Reflectance Index calculated according to ASTM E-1980.

\*Low Gloss/Low Sheen, 70% PVDF finish \*\* Appearance differs for Black Aluminum and Matte Black Steel \*\*\* 10-year finish warranty

## ENERGY STAR PERFORMANCE CRITERIA:

Emissivity uses ASTM C1371 Reflectivity uses ASTM C1549.

## TECHNICAL DATA FOR KYNAR 500/HYLAR 5000 COATING:

- ▶ South Florida Exposure: Color (ASTM D 2244) - No more than 5ΔE Hunter units at 20 years; Chalk (ASTM D 4214) - Rating no less than 8 at 20 years; Film integrity - 20 years.
- ▶ Accelerated Weathering (ASTM D 4587, ASTM G 154): 5000 Hours; Chalk, per ASTM D 4214, rating of 6 or better; Color, per ASTM D 2244, < 5ΔE (Hunter Units) color change.

- ▶ Humidity Resistance (ASTM D 2247): Galvalume or HDG, 100% RH, 2000 hours - No field blisters; Aluminum, 100% RH, 3000 hours - No field blisters
- ▶ Salt Spray Resistance (ASTM B 117): Aluminum, 3000 hours, Galvalume or HDG, 1000 hours - Creep from scribe no more than 1/16", no field blisters
- ▶ Chemical/Acid Pollution Resistance (ASTM D 1308): Pass
- ▶ T-Bend (ASTM D 4145): 1T - 3T with no loss of adhesion
- ▶ Pencil hardness (ASTM D 3363): HB - 2H
- ▶ Specular Gloss (ASTM D 523) @ 60 degrees: Typical - 20 - 35

- ▶ Abrasion Resistance (ASTM D 968): 67 +/- 10 liters
- ▶ Cross Hatch Adhesion (ASTM D 3359): No loss of adhesion
- ▶ Reverse Impact (ASTM D 2794): Galvalume or HDG, 2x metal thickness inch-pounds, no loss of adhesion; Aluminum, 1.5x metal thickness inch-pounds, no loss of adhesion
- ▶ Flame Test (ASTM E 84): Class A Coating

# Textures

✓ INDICATES SELECTED OPTIONS  
FOR THE FOSSNER RESIDENCE,  
7 FAIRLAWN AVE.

ReCon currently offers its licensed manufacturers a choice of five types of face textures. Most producers choose one of these textures as their standard and elect to maintain a working inventory of that texture. Other textures may still be available as a special-order. As with most special-order items, additional costs may be involved and sufficient time should be allowed for setup and production. Check with the ReCon licensed manufacturer in your market to determine what textures are available.

## Le Sueur County Limestone

This texture offers the look of broken and weathered limestone and lends itself well to accent staining. When certain stain colors are used, Le Sueur County Limestone can also take on the appearance of a weathered sandstone material.



## North Shore Granite

Granite may be the most recognized natural stone on earth. While its coloration varies widely, the texture of unprocessed granite is somewhat consistent in the way it fractures. Stained or unstained, the appearance of North Shore Granite is almost indistinguishable from weathered natural stone.



## Old World

The Old World texture was originally developed as a special-order item to match the appearance of the popular cut stone building materials used in the late 1800's and early 1900's. Many different types of stone were used in this manner and the Old World texture can emulate most of them depending on the stains that are used. The face also lends itself to further processing, such as sand blasting or exposed aggregates.

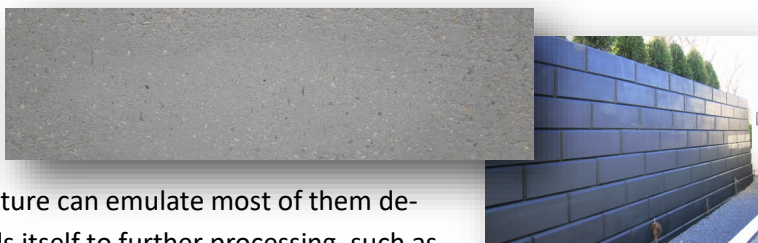

## Rustic

The Rustic texture captures the authenticity of a natural weathered cut stone that has been stacked in 8-inch coursing. The length of the individual stones varies from as little as 8-inches to as much as 26-inches, resulting in a natural random pattern.



## Weathered Edge

With Weathered Edge, ReCon has carefully selected individual stones that offer depth and richness of texture and range of stone sizes. Stone heights range from 3 to 16-inches and widths range from 9 to 48-inches. The stones have been placed into a number of patterns that blend together to create an authentic and natural stone wall appearance.



# GLOW STAR LED

IP66 RATED

DATE:

PROJECT:

TYPE:



**INDICATES SELECTED OPTIONS  
FOR THE FOSSNER RESIDENCE,  
7 FAIRLAWN AVE.**

CATALOG NUMBER LOGIC:



*\*Designed for use with 12 VAC. transformer.  
Requires magnetic low voltage dimmer.*

*\*\*Please see Adjust-e-Lume photometry to  
determine desired intensity.*

*\*\*\*105-300 VAC. 50/60 Hz. non-dimming.*

*\*\*\*\*Available on style 'G' only. Requires vector  
based graphics file by others.*

## CATALOG NUMBER LOGIC

Example: GL - LED - e65 - A7 - BZP - G-6 - 6 - PP12 - TRe20 - ART

## MATERIAL

(Blank) - Aluminum B - Brass S - Stainless Steel

## SERIES

GL - Glow Star

## SOURCE

LED - with Integral Dimming Driver (25W min. load when dimmed)\*

## LED TYPE

e64 - 7W LED/2700K e66 - 7W LED/4000K

e65 - 7W LED/3000K e74 - 7W LED/Amber

## ADJUST-E-LUME OUTPUT INTENSITY\*\*

A9 (Standard), A8, A7, A6, A5, A4, A3, A2, A1

## FINISH (See page 2 for full-color swatches)

Standard Finishes (BZP, BZW, BLP, BLW, WHP, WHW, SAP, VER)

Premium Finish (ABP, AMG, AQW, BCM, BGE, BPP, CAP, CMG, CRI, CRM, HUG, MDS, NBP, OCP, RMG, SDS, SMG, TXF, WCP, WIR)

Also available in RAL Finishes

Brass Finishes (MAC, POL, MIT)

Stainless Steel Finishes (MAC, POL)

## STYLE

E

K, L

J, N1, P1, R1

G (Specify graphic panel height: 4", 6", 9")

## BASE HEIGHT

2" - with 1/2" Female Pipe Thread Base (Standard), 6", 12", 18", 24" - with Anchor Base

## MOUNTING OPTIONS

For 2" Base Models

PP12B - 12" Power Pipe Stake with 'B' Cap

PP18B - 18" Power Pipe Stake with 'B' Cap

For 6", 12", 18", 24" Base Models

PP12 - 12" Power Pipe Stake

PP18 - 18" Power Pipe Stake

TRe20 - TRe20 Electronic Transformer (For use with LED fixtures)\*\*\*

SF - Stability Flange (For use with Power Pipe)

## OPTIONS

ART - Laser Engraved Graphics\*\*\*\*

**B-K LIGHTING**

**MADE IN THE USA**

559.438.5800 | INFO@BKLIGHTING.COM | BKLIGHTING.COM

THIS DOCUMENT CONTAINS PROPRIETARY INFORMATION OF B-K LIGHTING, INC. AND ITS RECEIPT OR POSSESSION DOES NOT CONVEY ANY RIGHTS TO REPRODUCE, DISCLOSE ITS CONTENTS, OR TO MANUFACTURE, USE OR SELL ANYTHING IT MAY DESCRIBE. REPRODUCTION, DISCLOSURE OR USE WITHOUT SPECIFIC WRITTEN AUTHORIZATION OF B-K LIGHTING, INC. IS STRICTLY FORBIDDEN.

03/03/2020 SKU-755  
SUB000941

DATE:

PROJECT:

TYPE:

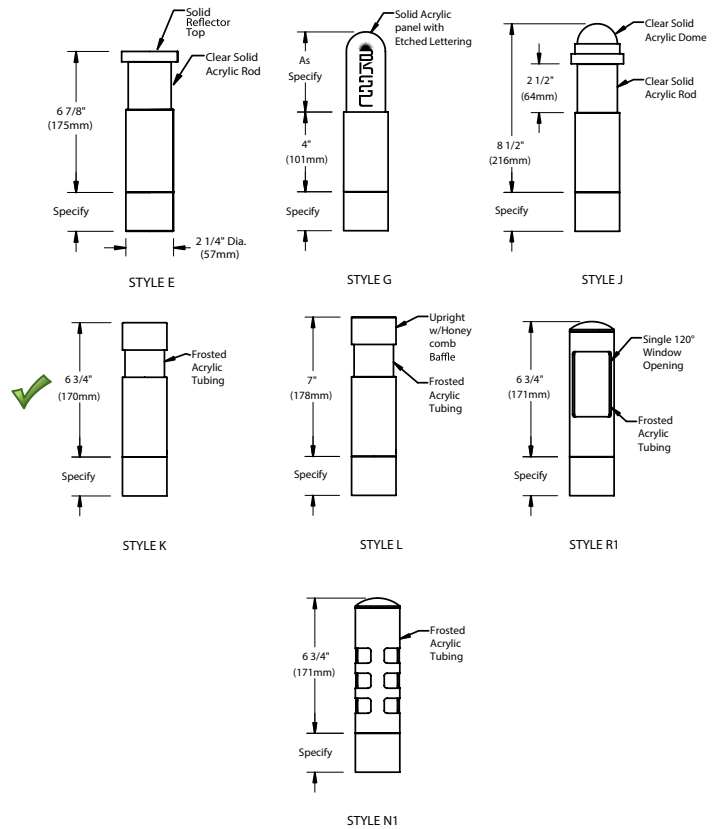
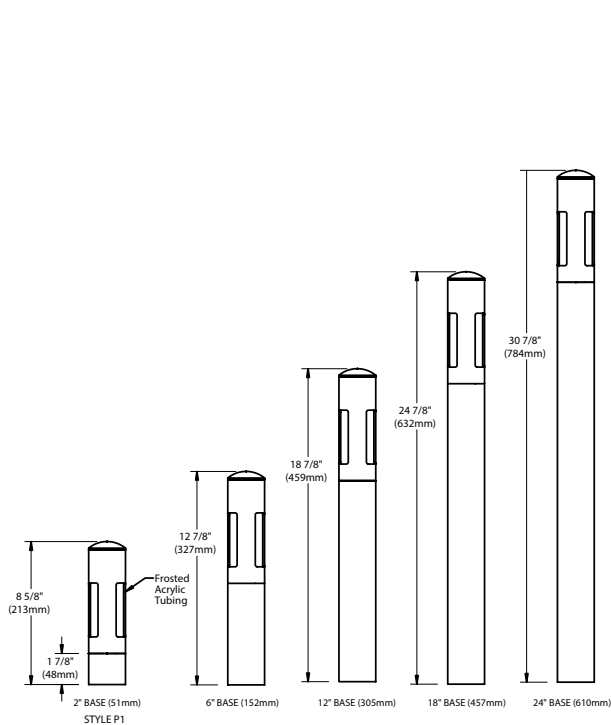

## STANDARD FINISHES



[Click Here](#) to view larger, full-color swatches of all available finishes on our website.

## PREMIUM FINISHES

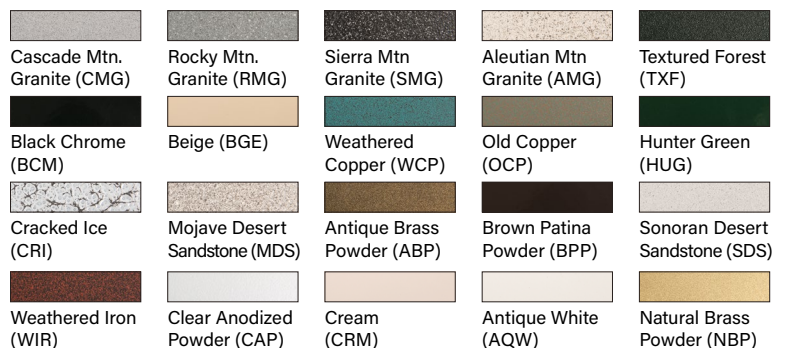

**B-K LIGHTING****MADE IN THE USA**559.438.5800 | [INFO@BKLIGHTING.COM](mailto:INFO@BKLIGHTING.COM) | [BKLIGHTING.COM](http://BKLIGHTING.COM)



DATE:	PROJECT:	TYPE:
-------	----------	-------

Accessories (Configure separately)

## SPECIFICATIONS

ELECTRICAL	WATTAGE	7W LED
	ADJUST-E-LUME	Integral electronics allow for dynamic lumen response at the individual fixture. Indexed (100% to 25% nom.) lumen output. Maintains output at desired level or may be changed. Specify factory preset output intensity.
	WIRING	Teflon® coated, 18AWG, 600V, 250° C rated and certified to UL 1659 standard.
	TRANSFORMER	For use with 12VAC remote transformer or magnetic transformers only. B-K Lighting cannot guarantee performance with third party manufacturers' transformers. Also available with optional integral, TRe20 electronic transformer. 105-300VAC primary voltage. 50/60Hz. Non Dimming. 20VA maximum load.
PHYSICAL	STYLE	Fully machined housing styles provide wide assortment of visual effects.
	MATERIALS	Furnished in copper-free aluminum (6061-T6). Style E is also available in brass (360) or stainless steel (316).
	BODY	Unibody design is fully machined from solid billet and provides enclosed, water-proof wireway and integral heat sink for maximum component life. High temperature, silicone 'O' Ring provides water-tight seal.
	LED	Integrated solid state system and modular design with electrical disconnects allows for easy field upgrade and maintenance. High power, forward throw source complies with ANSI C78.377 binning requirements and exceeds ENERGY STAR® lumen maintenance requirements. LM-80 certified components. Integral, constant current driver. 12VAC/VDC input. 50/60Hz. Proprietary input control scheme achieves power factor correction and eliminates inrush current (limited to <250mA non-dimming). Output, overvoltage, open-circuit, and short circuit protected. Conforms to Safety Std. C22.2 No. 250.13-12.
	DIMMING	Line voltage dimmable via magnetic low voltage dimmer with dedicated neutral conductor. Remote magnetic transformer with LED loads should be loaded to 25% of the transformer VA (watts) rated value.
	INSTALLATION	2" base features 1/2" female pipe thread for mounting (hardware by others). 6-24" bases feature machined anchor base with 7/8" dia. slip conduit hole and three (3) 3/16" dia. anchor bolt holes (hardware by others). Available in standard increments to facilitate fixture elevation above grade. Optional 12" or 18" Power Pipe for direct burial into soil or concrete, which additionally features optional 6" diameter, molded stability flange to simplify installation and projects into substrate to reinforce housing stability.
	HARDWARE	Tamper-resistant, stainless steel hardware.
	FINISH	StarGuard, our 15-stage chromate-free process cleans and conversion coats aluminum components prior to application of Class 'A' TGIC polyester powder coating and is RoHS compliant. Powder coat or metal finish options available for brass material and metal finish option only for stainless steel material.
	WARRANTY	5-year limited warranty.
	CERTIFICATION & LISTING	ITL tested to IESNA LM-79. UL Listed. Certified to CAN/CSA/ANSI Standards. RoHS compliant. Suitable for indoor or outdoor use, in wet locations, and for installation within 4' of the ground. IP66 Rated. Made in the USA with sustainable processes.
  		

**B-K LIGHTING**
**MADE IN THE USA**
**559.438.5800 | INFO@BKLIGHTING.COM | BKLIGHTING.COM**

## LAMP & DRIVER DATA (e64, e65, e66, e74)

DATE:

PROJECT:

TYPE:

### DRIVER DATA

Input Volts	InRush Current	Operating	Dimmable	Operation Ambient Temperature
12VAC/DC 50/60Hz	<250mA (non-dimmed)	700mA	Magnetic Low Voltage Dimmer	-10°F-130°F (-12°C-54°C)

### LM79 DATA

BK No.	CCT (Typ.)	CRI (Typ.)	Input Watts (Typ.)
e64	2700K	80	7
e65	3000K	80	7
e66	4000K	80	7
e74	Amber (590nm)	~	7

### L70 DATA

Minimum Rated Life (hrs.) 70% of initial lumens ( $L_{70}$ )
50,000
50,000
50,000
50,000

**B-K LIGHTING**

**MADE IN THE USA**

559.438.5800 | [INFO@BKLIGHTING.COM](mailto:INFO@BKLIGHTING.COM) | [BKLIGHTING.COM](http://BKLIGHTING.COM)

THIS DOCUMENT CONTAINS PROPRIETARY INFORMATION OF B-K LIGHTING, INC. AND ITS RECEIPT OR POSSESSION DOES NOT CONVEY ANY RIGHTS TO REPRODUCE, DISCLOSE ITS CONTENTS, OR TO MANUFACTURE, USE OR SELL ANYTHING IT MAY DESCRIBE. REPRODUCTION, DISCLOSURE OR USE WITHOUT SPECIFIC WRITTEN AUTHORIZATION OF B-K LIGHTING, INC. IS STRICTLY FORBIDDEN.

04/22/2020  
SUB-2586-05



# VERSA STAR LED (JUNCTION BOX)

IP65 RATED

DATE:

PROJECT:

TYPE:



**INDICATES SELECTED OPTIONS  
FOR THE FOSSNER RESIDENCE,  
7 FAIRLAWN AVE.**

CATALOG NUMBER LOGIC:

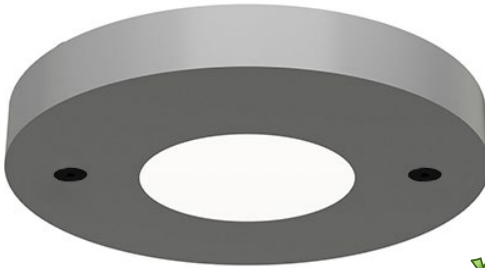

## CATALOG NUMBER LOGIC

Example: B - VS - LED - e103 - WFL - A4 - BLW - 13 - 11

## MATERIAL

(Blank) - Aluminum B - Brass S - Stainless Steel

## INSTALLATION

(Blank) - Back Box

## SERIES

VS - Versa Star

## SOURCE

LED - with Integral Dimming Driver (25W min. load when dimmed)\*

## LED TYPE

e100 - 5W LED/2700K e102 - 5W LED/4000K  
e101 - 5W LED/3000K e103 - 5W LED/Amber

## OPTICS

NSP - Narrow Spot (13°) MFL - Medium Flood (23°)  
SP - Spot (16°) WFL - Wide Flood (31°)

## ADJUST-E-LUME OUTPUT INTENSITY\*\*

A9 (Standard), A8, A7, A6, A5, A4, A3, A2, A1

## FINISH (See page 2 for full-color swatches)

Standard Finishes (BZP, BZW, BLP, BLW, WHP, WHW, SAP, VER)

Premium Finish (ABP, AMG, AQW, BCM, BGE, BPP, CAP, CMG, CRI, CRM, HUG, MDS, NBP, OCP, RMG, SDS, SMG, TXF, WCP, WIR)

Also available in RAL Finishes

Brass Finishes (MAC, POL, MIT)

Stainless Steel Finishes (MAC, POL)

## LENS TYPE

12 - Soft Focus 13 - Rectilinear

## SHIELDING

11 - Honeycomb Baffle

\*Requires magnetic low voltage dimmer.

\*\*Please see Adjust-e-Lume photometry to determine desired intensity.

**B-K LIGHTING**

**MADE IN THE USA**

559.438.5800 | INFO@BKLIGHTING.COM | BKLIGHTING.COM

THIS DOCUMENT CONTAINS PROPRIETARY INFORMATION OF B-K LIGHTING, INC. AND ITS RECEIPT OR POSSESSION DOES NOT CONVEY ANY RIGHTS TO REPRODUCE, DISCLOSE ITS CONTENTS, OR TO MANUFACTURE, USE OR SELL ANYTHING IT MAY DESCRIBE. REPRODUCTION, DISCLOSURE OR USE WITHOUT SPECIFIC WRITTEN AUTHORIZATION OF B-K LIGHTING, INC. IS STRICTLY FORBIDDEN.

01/31/2020 SKU-771  
SUB001016

# VERSA STAR LED (JUNCTION BOX)

IP65 RATED

DATE:	PROJECT:	TYPE:
-------	----------	-------

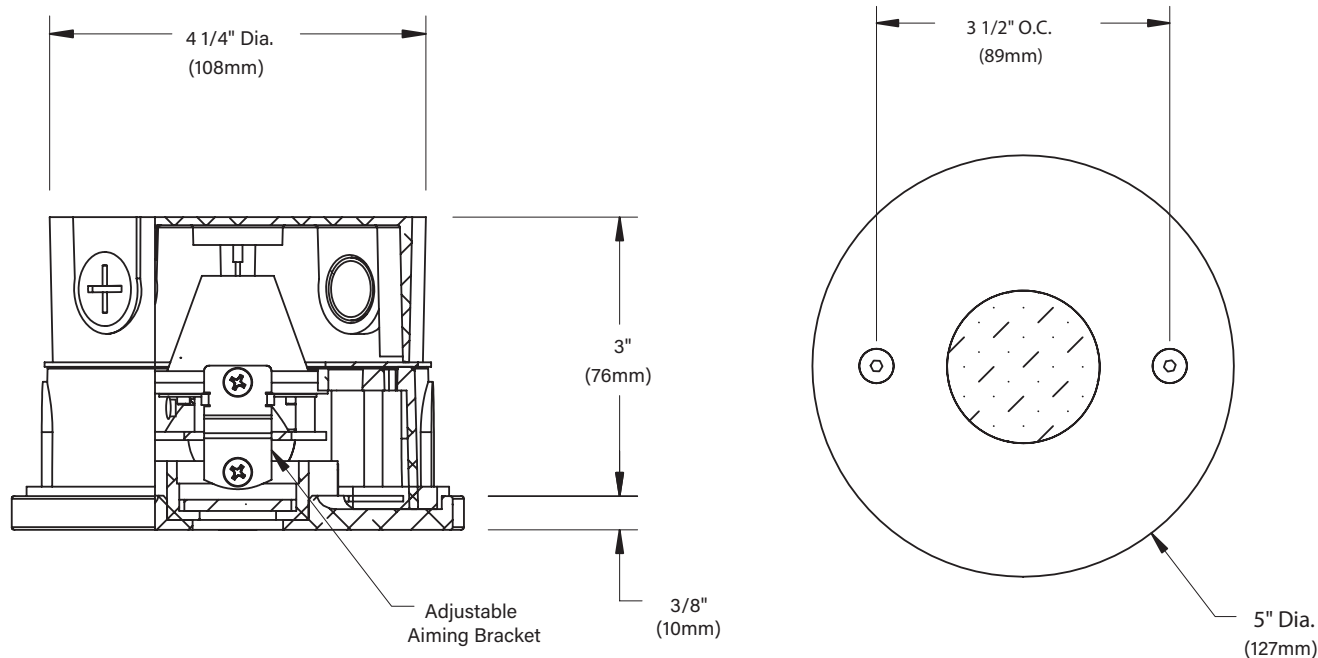

## STANDARD FINISHES



[Click Here](#) to view larger, full-color swatches of all available finishes on our website.

## PREMIUM FINISHES



**B-K LIGHTING**

**MADE IN THE USA**

559.438.5800 | [INFO@BKLIGHTING.COM](mailto:INFO@BKLIGHTING.COM) | [BKLIGHTING.COM](http://BKLIGHTING.COM)

THIS DOCUMENT CONTAINS PROPRIETARY INFORMATION OF B-K LIGHTING, INC. AND ITS RECEIPT OR POSSESSION DOES NOT CONVEY ANY RIGHTS TO REPRODUCE, DISCLOSE ITS CONTENTS, OR TO MANUFACTURE, USE OR SELL ANYTHING IT MAY DESCRIBE. REPRODUCTION, DISCLOSURE OR USE WITHOUT SPECIFIC WRITTEN AUTHORIZATION OF B-K LIGHTING, INC. IS STRICTLY FORBIDDEN.

01/31/2020 SKU-771  
SUB001016

# VERSA STAR LED (JUNCTION BOX)

IP65 RATED

DATE:	PROJECT:	TYPE:
-------	----------	-------

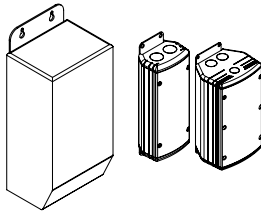

Accessories (Configure separately)



TR Series

UPMRM

## SPECIFICATIONS

ELECTRICAL	WATTAGE	5W LED
	ADJUST-E-LUME	Integral electronics allows dynamic lumen response at the individual fixture. Indexed (100% to 25% nom.) lumen output. Maintains output at desired level or may be changed. Specify factory preset output intensity.
	WIRING	Teflon® coated, 18AWG, 600V, 250° C rated and certified to UL 1659 standard.
	REMOTE TRANSFORMER	For use with 12VAC remote transformer or magnetic transformers only. B-K Lighting cannot guarantee performance with third party manufacturers' transformers.
PHYSICAL	MATERIALS	Furnished in copper-free aluminum (6061-T6), brass (360) or stainless steel (304).
	BACK BOX	Round, 4-1/4" dia. x 3-1/8" deep construction with two (2) mounting tabs. Front access for wire connection and inspection. Provided with five (5) 1/2" NPS tapped holes and four (4) plugs. Suitable for concrete pour.
	FACEPLATE	Fully machined from solid billet. Countersunk holes provide for flush hardware mounting with two (2) tamper-resistant, stainless steel mounting screws. Stainless steel universal mounting ring for faceplate adjustment and 1/8" thick HT-805A silicone foam gasket with acrylic adhesive for water-tight seal. Accommodates one (1) lens or louver media.
	LENS	Shock resistant, tempered, glass lens is factory adhered to faceplate.
	LED	Integrated solid state system is scalable for field upgrade. Modular design with electrical quick disconnects permit field maintenance. High power, forward throw source complies with ANSI C78.377 binning requirements. Exceeds ENERGY STAR® lumen maintenance requirements. LM-80 certified components. Integral, constant current driver. 12VAC/VDC input. 50/60Hz. Proprietary input control scheme achieves power factor correction and eliminates inrush current. Output, overvoltage, open-circuit, and short circuit protected. Inrush current limited to <1A (non-dimming). Conforms to Safety Std. C22.2 No. 250.13-12.
	DIMMING	Line voltage dimmable via magnetic low voltage dimmer with dedicated neutral conductor. Remote magnetic transformer with LED loads should be loaded to 25% of the transformer VA (watts) rated value.
	OPTICS	Interchangeable OPTIKIT modules permit optical field changes. Color-code: Spot (SP) = green; Medium Flood (MFL) = yellow; Flood (FL) = blue.
	AIMING & CONTROL	Adjustable optical bracket provides up to 24° vertical aiming.
	HARDWARE	Tamper-resistant, stainless steel hardware. Faceplate screws are black oxide treated for additional corrosion resistance.
	FINISH	StarGuard, our 15-stage chromate-free process cleans and conversion coats aluminum components prior to application of Class 'A' TGIC polyester powder coating and is RoHS compliant. Powder coat or metal finish options available for brass material and metal finish option only for stainless steel material.
  	WARRANTY	5-year limited warranty.
	CERTIFICATION & LISTING	ITL tested to IESNA LM-79. UL Listed. Certified to CAN/CSA/ANSI Standards. RoHS compliant. Suitable for indoor or outdoor use, in wet locations, and for installation within 4' of the ground. IP65 Rated. Made in the USA with sustainable processes.

**B-K LIGHTING**

**MADE IN THE USA**

559.438.5800 | INFO@BKLIGHTING.COM | BKLIGHTING.COM

THIS DOCUMENT CONTAINS PROPRIETARY INFORMATION OF B-K LIGHTING, INC. AND ITS RECEIPT OR POSSESSION DOES NOT CONVEY ANY RIGHTS TO REPRODUCE, DISCLOSE ITS CONTENTS, OR TO MANUFACTURE, USE OR SELL ANYTHING IT MAY DESCRIBE. REPRODUCTION, DISCLOSURE OR USE WITHOUT SPECIFIC WRITTEN AUTHORIZATION OF B-K LIGHTING, INC. IS STRICTLY FORBIDDEN.

01/31/2020 SKU-771  
SUB001016

LAMP & DRIVER DATA (e100, e101, e102, e103)

DATE:

PROJECT:

TYPE:

CATALOG NUMBER LOGIC:

DRIVER DATA	Input Volts	InRush Current	Operating	Dimmable	Operation Ambient Temperature
	12VAC/DC 50/60Hz	<250mA (non-dimmed)	500mA	Magnetic Low Voltage Dimmer	-22°F-194°F (-30°C - 90°C)

LM79 DATA				L70 DATA	OPTICAL DATA		
BK No.	CCT (Typ.)	CRI (Typ.)	Input Watts (Typ.)	Minimum Rated Life (hrs.) 70% of initial lumens (L <sub>70</sub> )	Angle	CBCP	Delivered Lumens
e100	2700K	80	5	50,000	13°	3938	309
	2700K	80	5	50,000	16°	2988	301
	2700K	80	5	50,000	23°	1134	269
	2700K	~	5	50,000	31°	743	271
e101	3000K	80	5	50,000	13°	4029	316
	3000K	80	5	50,000	16°	3056	308
	3000K	80	5	50,000	23°	1161	275
	3000K	~	5	50,000	31°	760	277
e102	4000K	80	5	50,000	13°	4527	355
	4000K	80	5	50,000	16°	3434	346
	4000K	80	5	50,000	23°	1304	309
	4000K	~	5	50,000	31°	854	311
e103	Amber (590nm)	~	5	50,000	~	~	~

OPTICS	
Optic	Angle
NSP - Narrow Spot	13°
SP - Spot	16°
MFL - Medium Flood	23°
WFL - Wide Flood	31°

B-K LIGHTING

MADE IN THE USA

559.438.5800 | INFO@BKLIGHTING.COM | BKLIGHTING.COM

THIS DOCUMENT CONTAINS PROPRIETARY INFORMATION OF B-K LIGHTING, INC. AND ITS RECEIPT OR POSSESSION DOES NOT CONVEY ANY RIGHTS TO REPRODUCE, DISCLOSE ITS CONTENTS, OR TO MANUFACTURE, USE OR SELL ANYTHING IT MAY DESCRIBE. REPRODUCTION, DISCLOSURE OR USE WITHOUT SPECIFIC WRITTEN AUTHORIZATION OF B-K LIGHTING, INC. IS STRICTLY FORBIDDEN.