



Briary Road Topo

Dobbs Ferry, NY



May 8, 2023

1 inch = 80 Feet

www.cai-tech.com

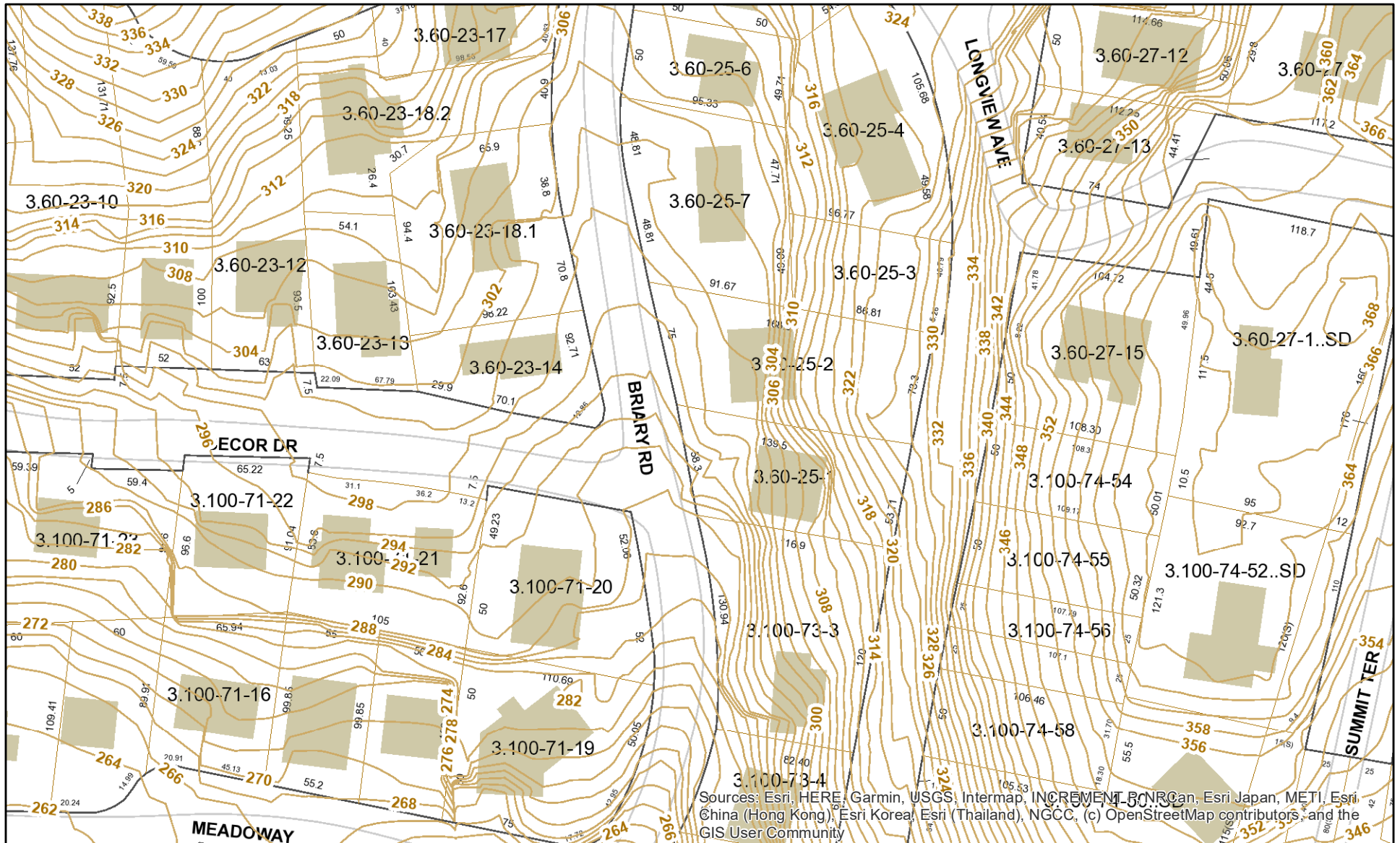

Sources: Esri, HERE, Garmin, USGS, Intermap, INCREMENTAL PRC, Esri Japan, METI, Esri China (Hong Kong), Esri Korea, Esri (Thailand), NGCC, (c) OpenStreetMap contributors, and the GIS User Community

Data displayed on this map is for informational purposes only. Most layers originate from 3rd parties and cannot be verified by the Tax Assessor's office or CAI Technologies. Please consult with department or organization where data originates in order to verify accuracy. Any questions, call Town Assessor's Office: 1-914-989-1520.



Dobbs Ferry, NY

1 inch = 80 Feet



www.cai-tech.com

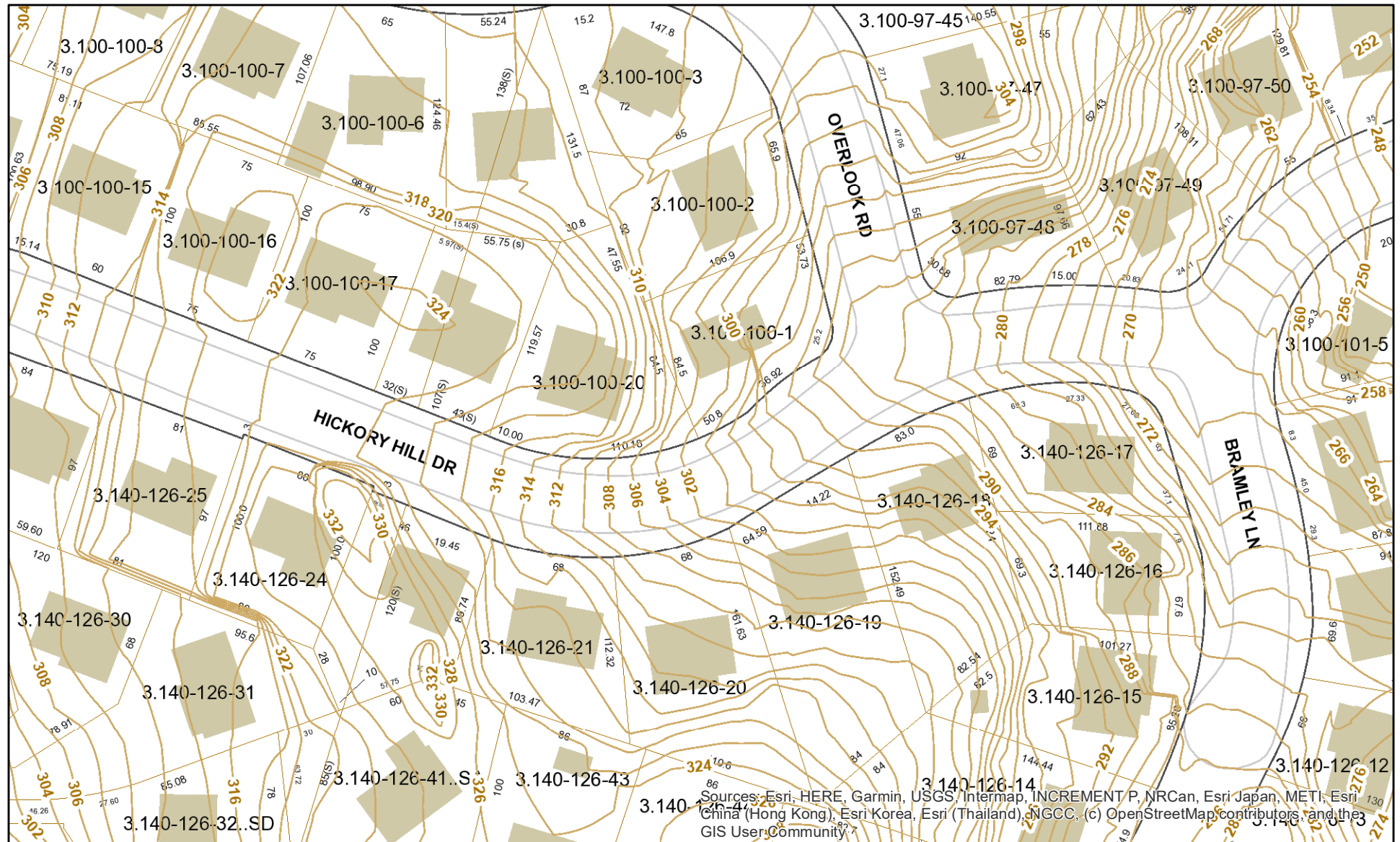

Data displayed on this map is for informational purposes only. Most layers originate from 3rd parties and cannot be verified by the Tax Assessor's office or CAI Technologies. Please consult with department or organization where data originates in order to verify accuracy. Any questions, call Town Assessor's Office: 1-914-989-1520.



Dobbs Ferry, NY

1 inch = 71 Feet

May 8, 2023



www.cai-tech.com

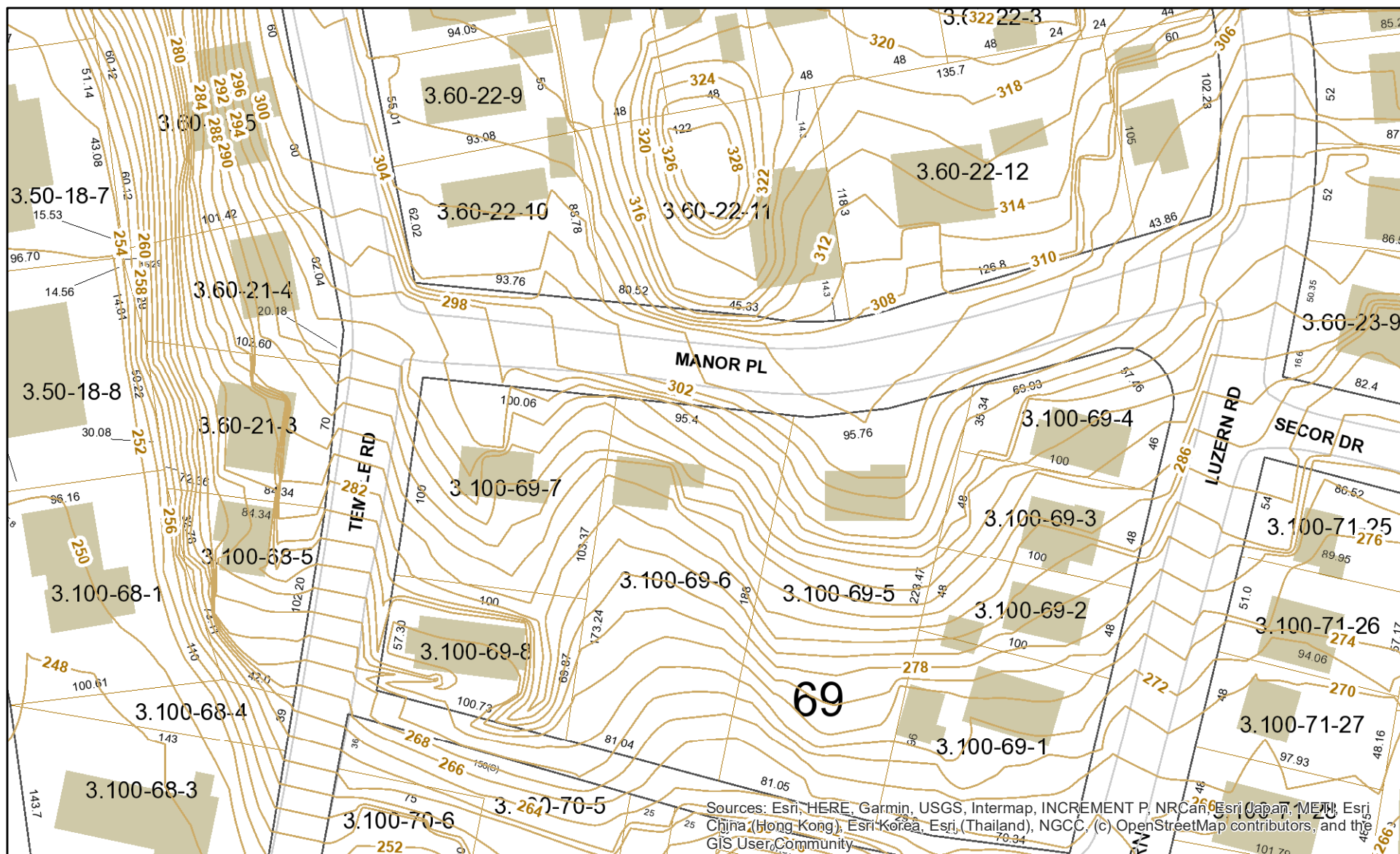

Data displayed on this map is for informational purposes only. Most layers originate from 3rd parties and cannot be verified by the Tax Assessor's office or CAI Technologies. Please consult with department or organization where data originates in order to verify accuracy. Any questions, call Town Assessor's Office: 1-914-989-1520.



Judson Avenue Topo

Dobbs Ferry, NY



May 8, 2023

1 inch = 80 Feet

www.cai-tech.com

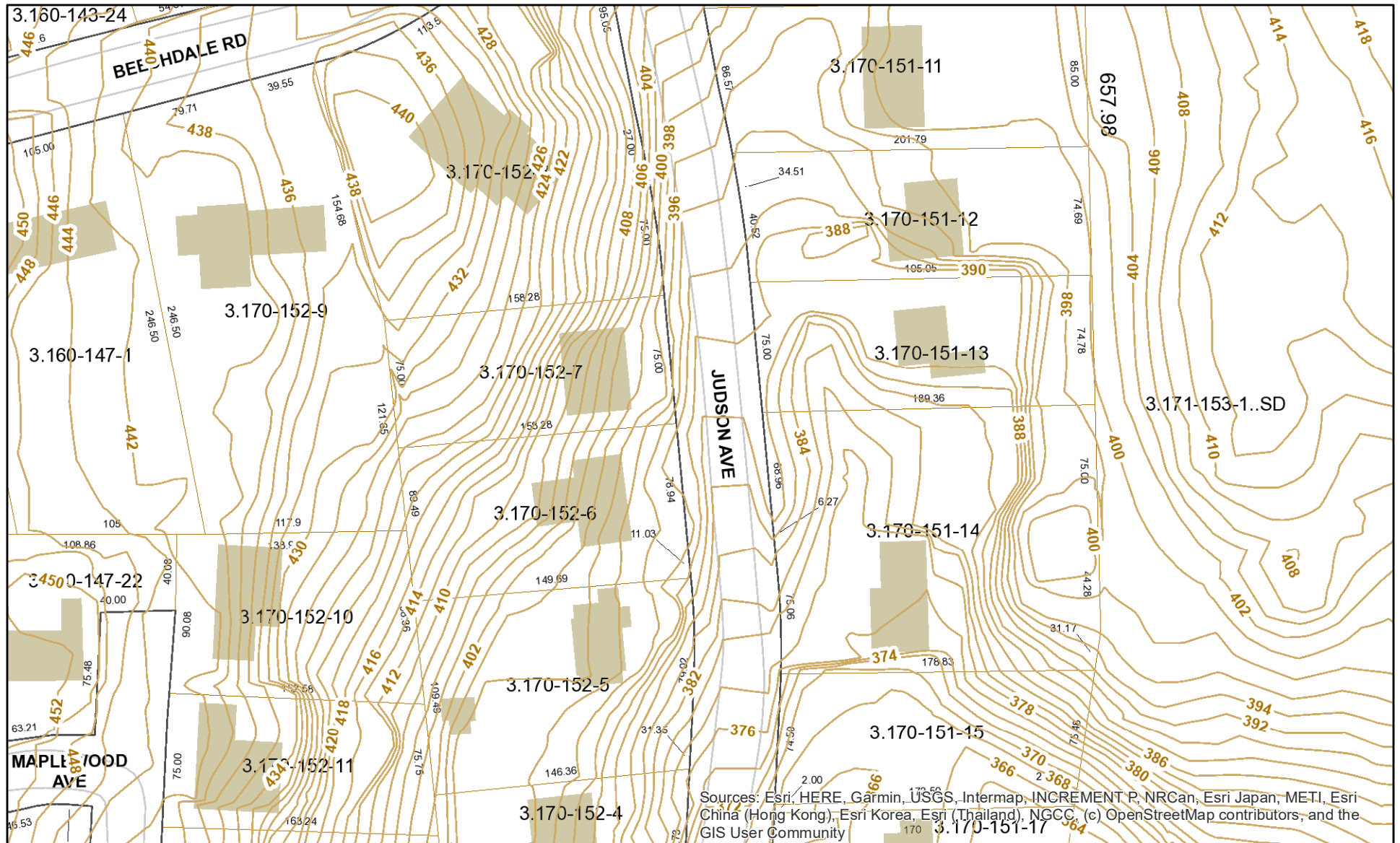

Sources: Esri, HERE, Garmin, USGS, Intermap, INCREMENT P, NRCan, Esri Japan, METI, Esri China (Hong Kong), Esri Korea, Esri (Thailand), NGCC, (c) OpenStreetMap contributors, and the GIS User Community

Data displayed on this map is for informational purposes only. Most layers originate from 3rd parties and cannot be verified by the Tax Assessor's office or CAI Technologies. Please consult with department or organization where data originates in order to verify accuracy. Any questions, call Town Assessor's Office: 1-914-989-1520.



Northfield Avenue Topo

Dobbs Ferry, NY



May 8, 2023

1 inch = 80 Feet

www.cai-tech.com

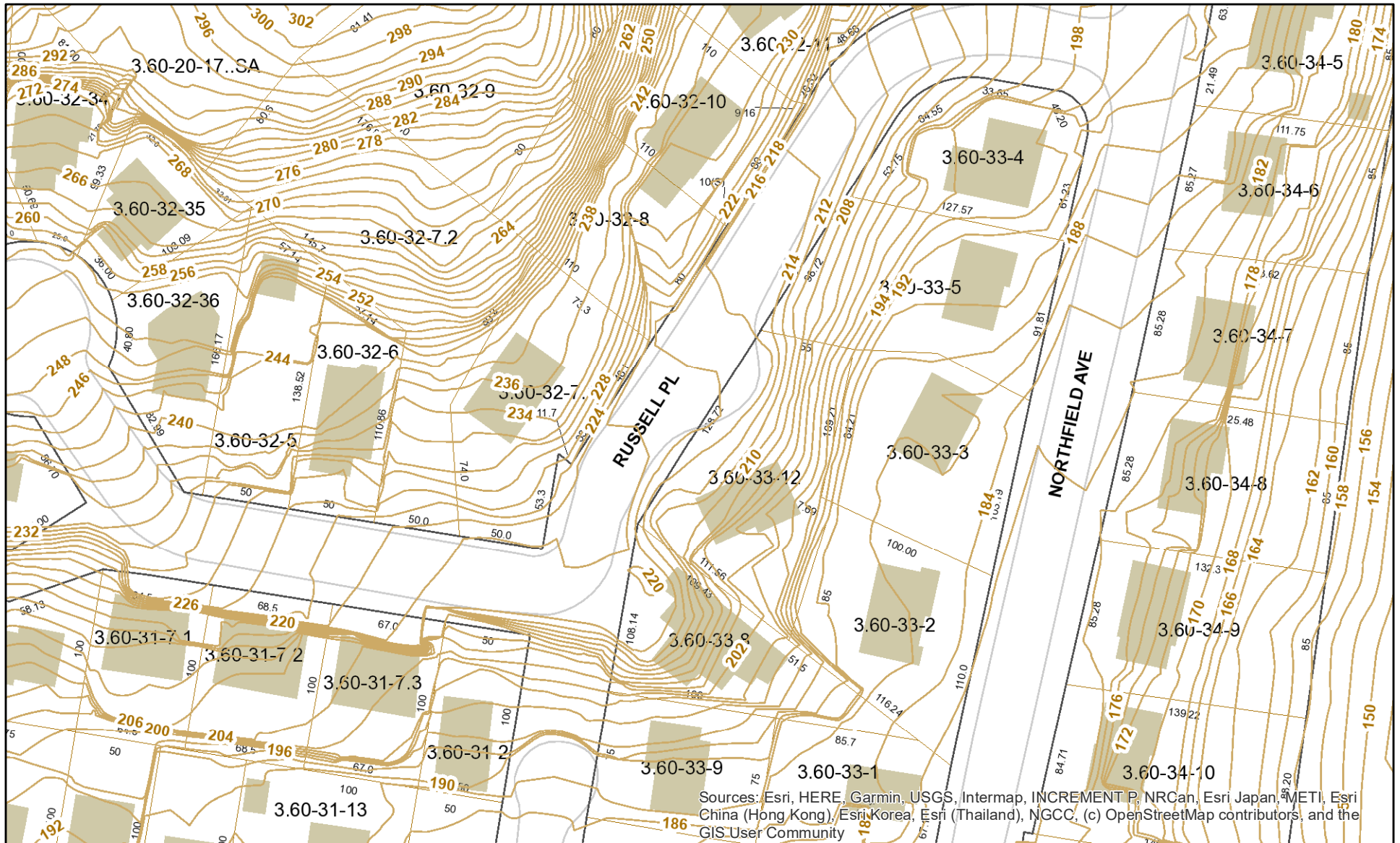

Sources: Esri, HERE, Garmin, USGS, Intermap, INCREMENT P, NRCan, Esri Japan, METI, Esri China (Hong Kong), Esri Korea, Esri (Thailand), NGCC, (c) OpenStreetMap contributors, and the GIS User Community

Data displayed on this map is for informational purposes only. Most layers originate from 3rd parties and cannot be verified by the Tax Assessor's office or CAI Technologies. Please consult with department or organization where data originates in order to verify accuracy. Any questions, call Town Assessor's Office: 1-914-989-1520.



Villard Hill Topo

Dobbs Ferry, NY



May 8, 2023

1 inch = 80 Feet

www.cai-tech.com

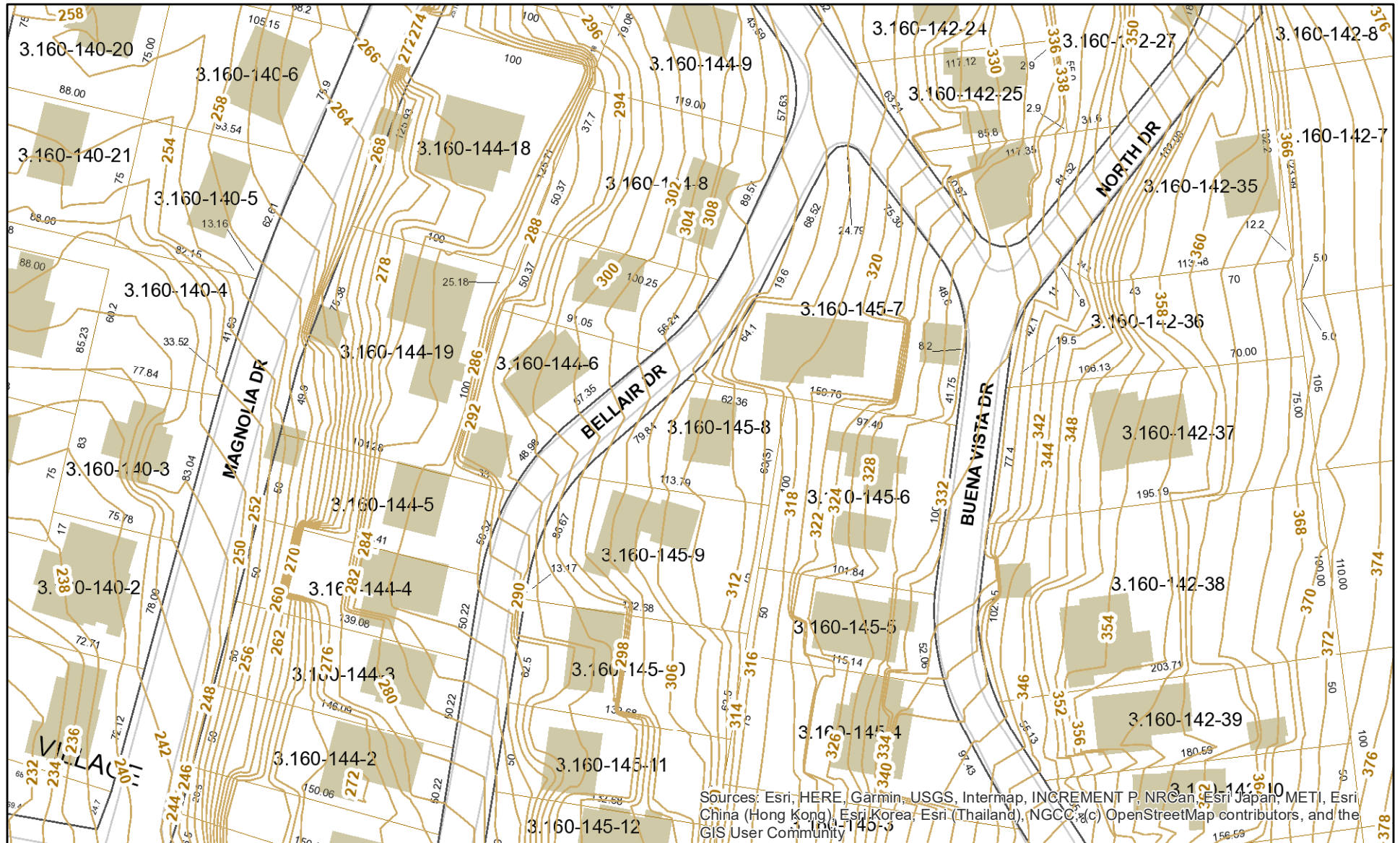

Sources: Esri, HERE, Garmin, USGS, Intermap, INCREMENT P, NRCan, Esri Japan, METI, Esri China (Hong Kong), Esri Korea, Esri (Thailand), NGCC, (c) OpenStreetMap contributors, and the GIS User Community

Data displayed on this map is for informational purposes only. Most layers originate from 3rd parties and cannot be verified by the Tax Assessor's office or CAI Technologies. Please consult with department or organization where data originates in order to verify accuracy. Any questions, call Town Assessor's Office: 1-914-989-1520.



Dobbs Ferry, NY

1 inch = 80 Feet

May 8, 2023



www.cai-tech.com

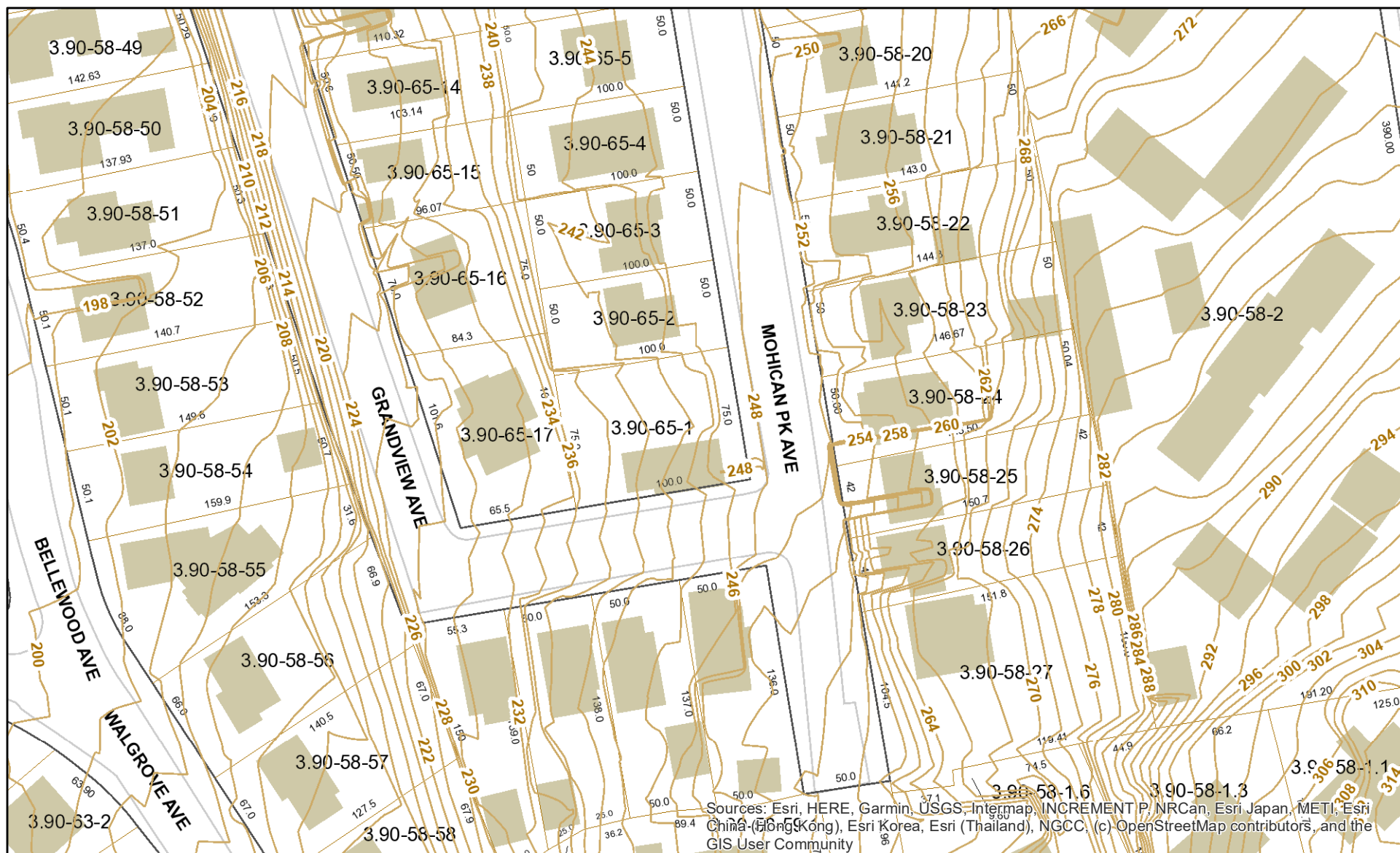

Data displayed on this map is for informational purposes only. Most layers originate from 3rd parties and cannot be verified by the Tax Assessor's office or CAI Technologies. Please consult with department or organization where data originates in order to verify accuracy. Any questions, call Town Assessor's Office: 1-914-989-1520.