

SLOPE ANALYSIS			
HATCH	RANGE	AREA	PERCENT
	0.0% - 35%	19001.51 SF	81.42%
	35% - <	4335.92 SF	18.58%
	TOTAL	23,337.43	100%

PROCESS DESCRIPTION:

TO PERFORM THE SLOPE ANALYSIS, A CAD SURVEY WITH TOPOGRAPHIC INFORMATION WAS IMPORTED INTO "REVIT" SOFTWARE TO MODEL A SURFACE WHICH PRECISELY FOLLOWS THE CONTOUR LINES FROM THE SURVEY. A REVIT PLUGIN CALLED "ENVIRONMENT" WAS USED TO INSERT THREE RANGE VALUES (0-35% AND 35% - <). THE RANGE PARAMETER THEN CALCULATED THE AREA AND PERCENT OF THE SLOPES WITHIN THE PROPERTY LINES. TO ACCURATELY PRESENT THESE AREAS, THREE HATCHES WERE CREATED TO DIAGRAM EACH RANGE VALUE. THE RESULTS WERE THEN EXPORTED INTO AUTOCAD FOR FINAL DOCUMENTATION.

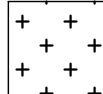

TO THE BEST OF MY KNOWLEDGE, BELIEF, AND PROFESSIONAL JUDGEMENT OF THE UNDERSIGNED, THE PLANS AND SPECIFICATIONS DEPICTED ON THESE DRAWINGS ARE IN COMPLIANCE WITH THE APPLICABLE PROVISIONS OF THE NEW YORK STATE UNIFORM FIRE PREVENTION AND BUILDING CODE AND THE NEW YORK STATE ENERGY CONSERVATION CONSTRUCTION CODE CURRENTLY IN EFFECT.



LAURA WAKEFIELD
ARCHITECT
329 BROADWAY
DOBBS FERRY, NY 10522
TEL: 914 693 6165
N.Y.S STATE LICENSE
No. 27038

WARNING:
IT IS A VIOLATION OF THE NEW YORK STATE EDUCATIONAL LAW ARTICLE 148 SECTION 7209 FOR ANY PERSON, UNLESS HE OR SHE IS ACTING UNDER THE DIRECTION OF A LICENSED PROFESSIONAL ARCHITECT, ENGINEER OR LAND SURVEYOR TO ALTER AN ITEM IN ANY WAY.

PROJECT TITLE:
GIGLIO PROPERTY
79 NORTH MOUNTAIN ROAD
DOBBS FERRY, N.Y. 10522
PROJECT NO.:

GOTHAM DESIGN
PLANNING AND DEVELOPMENT LTD.



329 Broadway
Dobbs Ferry, N.Y. 10522
Phone: (914) 693-5093
Fax: (914) 693-5390
email: arch329@gmail.com

ISSUED / REVISIONS

SHEET TITLE:
SLOPE ANALYSIS

DATE: 06/15/2022	DRAWN BY: SSJ
SCALE: AS NOTED	CHECKED BY: PRS

A-1.2

SLOPE ANALYSIS			
HATCH	RANGE	AREA	PERCENT
	0.0% - 35%	19001.51 SF	81.42%
	35% - <	4335.92 SF	18.58%
	TOTAL	23,337.43	100%

PROCESS DESCRIPTION:

TO PERFORM THE SLOPE ANALYSIS, A CAD SURVEY WITH TOPOGRAPHIC INFORMATION WAS IMPORTED INTO "REVIT" SOFTWARE TO MODEL A SURFACE WHICH PRECISELY FOLLOWS THE CONTOUR LINES FROM THE SURVEY. A REVIT PLUGIN CALLED "ENVIRONMENT" WAS USED TO INSERT THREE RANGE VALUES (0-35% AND 35% - <). THE RANGE PARAMETER THEN CALCULATED THE AREA AND PERCENT OF THE SLOPES WITHIN THE PROPERTY LINES. TO ACCURATELY PRESENT THESE AREAS, THREE HATCHES WERE CREATED TO DIAGRAM EACH RANGE VALUE. THE RESULTS WERE THEN EXPORTED INTO AUTOCAD FOR FINAL DOCUMENTATION.

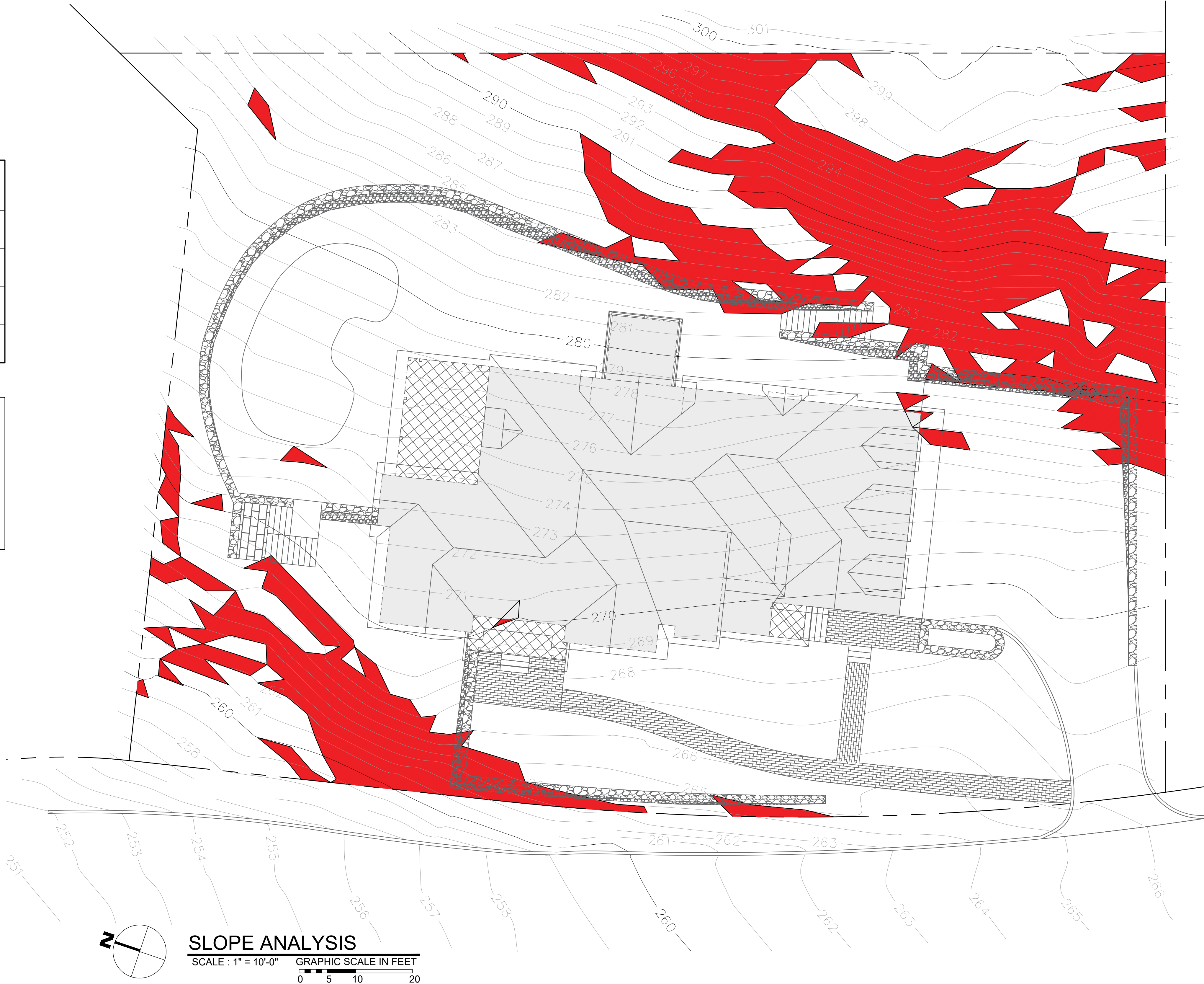

TO THE BEST OF MY KNOWLEDGE, BELIEF, AND PROFESSIONAL JUDGEMENT OF THE UNDERSIGNED, THE PLANS AND SPECIFICATIONS DEPICTED ON THESE DRAWINGS ARE IN COMPLIANCE WITH THE APPLICABLE PROVISIONS OF THE NEW YORK STATE UNIFORM FIRE PREVENTION AND BUILDING CODE AND THE NEW YORK STATE ENERGY CONSERVATION CONSTRUCTION CODE CURRENTLY IN EFFECT



LAURA WAKEFIELD
ARCHITECT
329 BROADWAY
DOBBS FERRY, NY 10522
TEL: 914 693 6165
N.Y.S STATE LICENSE
No. 27038

WARNING:
IT IS A VIOLATION OF THE NEW YORK STATE EDUCATIONAL LAW ARTICLE 148 SECTION 7209 FOR ANY PERSON, UNLESS HE OR SHE IS ACTING UNDER THE DIRECTION OF A LICENSED PROFESSIONAL ARCHITECT, ENGINEER OR LAND SURVEYOR TO ALTER AN ITEM IN ANY WAY.

PROJECT TITLE:
GIGLIO PROPERTY
79 NORTH MOUNTAIN ROAD
DOBBS FERRY, N.Y. 10522
PROJECT NO.:

GOTHAM DESIGN
PLANNING AND DEVELOPMENT LTD.



329 Broadway
Dobbs Ferry, N.Y. 10522
Phone: (914) 693-5093
Fax: (914) 693-5390
email: arch329@gmail.com

ISSUED / REVISIONS

SHEET TITLE:
SLOPE ANALYSIS

DATE: 06/15/2022	DRAWN BY: SSJ
SCALE: AS NOTED	CHECKED BY: PRS

A-1.2

SLOPE ANALYSIS					
HATCH	RANGE	AREA	PERCENT	DEDUCTIONS	
	0.0% - 15%	3,184.38 SF	13.6%	0.0%	
	15% - 25%	9,819.2 SF	42.1%	25%	2,454.8
	25% - <	10,333.4 SF	44.3%	50%	5,166.7
	TOTAL	23,337.43	100%		7,621.5

PROCESS DESCRIPTION:

TO PERFORM THE SLOPE ANALYSIS, A CAD SURVEY WITH TOPOGRAPHIC INFORMATION WAS IMPORTED INTO "REVIT" SOFTWARE TO MODEL A SURFACE WHICH PRECISELY FOLLOWS THE CONTOUR LINES FROM THE SURVEY. A REVIT PLUGIN CALLED "ENVIRONMENT" WAS USED TO INSERT THREE RANGE VALUES (0-15%, 15-25%, AND 25% - <). THE RANGE PARAMETER THEN CALCULATED THE AREA AND PERCENT OF THE SLOPES WITHIN THE PROPERTY LINES. TO ACCURATELY PRESENT THESE AREAS, THREE HATCHES WERE CREATED TO DIAGRAM EACH RANGE VALUE. THE RESULTS WERE THEN EXPORTED INTO AUTOCAD FOR FINAL DOCUMENTATION.

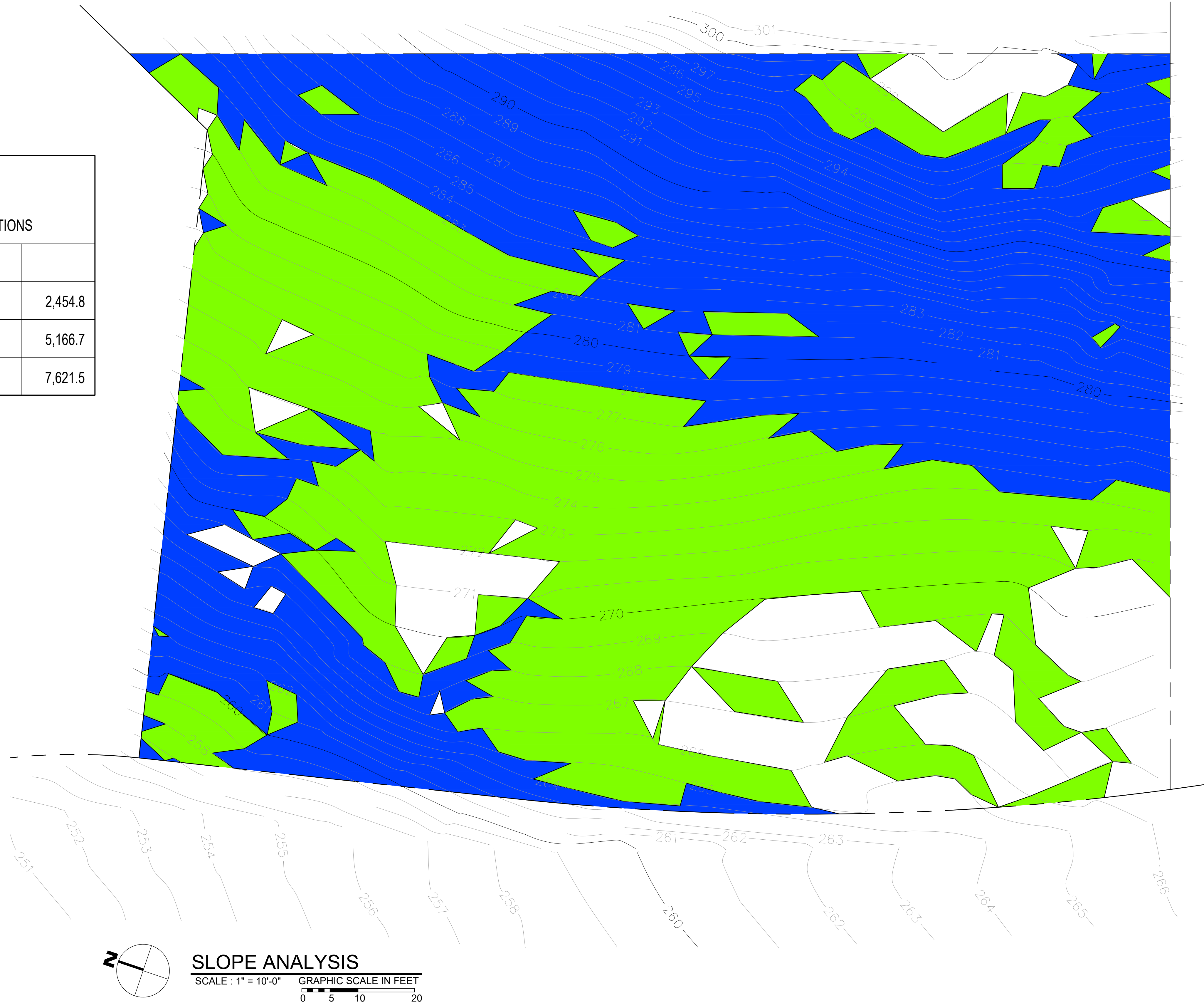

TO THE BEST OF MY KNOWLEDGE, BELIEF, AND PROFESSIONAL JUDGEMENT OF THE UNDERSIGNED, THE PLANS AND SPECIFICATIONS DEPICTED ON THESE DRAWINGS ARE IN COMPLIANCE WITH THE APPLICABLE PROVISION OF THE NEW YORK STATE UNIFORM FIRE PREVENTION AND BUILDING CODE AND THE NEW YORK STATE ENERGY CONSERVATION CONSTRUCTION CODE CURRENTLY IN EFFECT

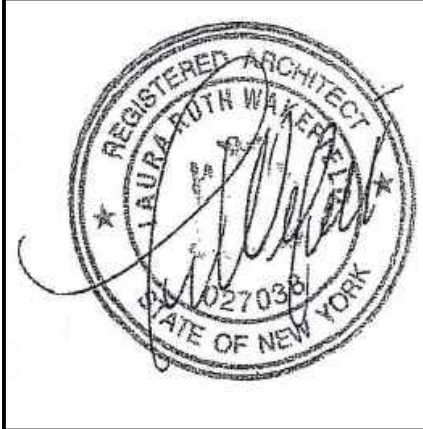

LAURA WAKEFIELD
ARCHITECT
329 BROADWAY
DOBBS FERRY, NY 10522
TEL: 914 693 6165
N.Y.S STATE LICENSE
No. 27038

WARNING:
IT IS A VIOLATION OF THE NEW YORK STATE EDUCATIONAL LAW ARTICLE 148 SECTION 7209 FOR ANY PERSON UNLESS HE OR SHE IS ACTING UNDER THE DIRECTION OF A LICENSED PROFESSIONAL ARCHITECT, ENGINEER OR LAND SURVEYOR TO ALTER AN ITEM IN ANY WAY.

PROJECT TITLE:
GIGLIO PROPERTY
79 NORTH MOUNTAIN ROAD
DOBBS FERRY, N.Y. 10522
PROJECT NO.:

GOTHAM DESIGN
PLANNING AND
DEVELOPMENT LTD.

329 Broadway
Dobbs Ferry, N.Y. 10522
Phone: (914) 693-5093
Fax: (914) 693-5390
email: arch329@gmail.com

ISSUED / REVISIONS

SHEET TITLE:
SLOPE ANALYSIS

DATE: 06/15/2022	DRAWN BY: SSJ
SCALE: AS NOTED	CHECKED BY: PRS

A-1.1

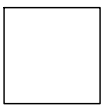
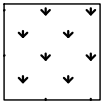
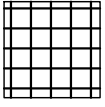
SLOPE ANALYSIS					
HATCH	RANGE	AREA	PERCENT	DEDUCTIONS	
	0.0% - 15%	3,184.38 SF	13.6%	0.0%	
	15% - 25%	9,819.2 SF	42.1%	25%	2,454.8
	25% - <	10,333.4 SF	44.3%	50%	5,166.7
	TOTAL	23,337.43	100%		7,621.5

PROCESS DESCRIPTION:

TO PERFORM THE SLOPE ANALYSIS, A CAD SURVEY WITH TOPOGRAPHIC INFORMATION WAS IMPORTED INTO "REVIT" SOFTWARE TO MODEL A SURFACE WHICH PRECISELY FOLLOWS THE CONTOUR LINES FROM THE SURVEY. A REVIT PLUGIN CALLED "ENVIRONMENT" WAS USED TO INSERT THREE RANGE VALUES (0-15%, 15-25%, AND 25% - <). THE RANGE PARAMETER THEN CALCULATED THE AREA AND PERCENT OF THE SLOPES WITHIN THE PROPERTY LINES. TO ACCURATELY PRESENT THESE AREAS, THREE HATCHES WERE CREATED TO DIAGRAM EACH RANGE VALUE. THE RESULTS WERE THEN EXPORTED INTO AUTOCAD FOR FINAL DOCUMENTATION.

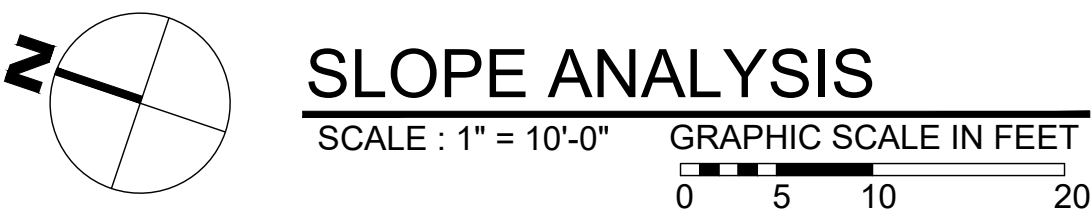

TO THE BEST OF MY KNOWLEDGE, BELIEF, AND PROFESSIONAL JUDGEMENT OF THE UNDERSIGNED, THE PLANS AND SPECIFICATIONS DEPICTED ON THESE DRAWINGS ARE IN COMPLIANCE WITH THE APPLICABLE PROVISION OF THE NEW YORK STATE UNIFORM FIRE PREVENTION AND BUILDING CODE AND THE NEW YORK STATE ENERGY CONSERVATION CONSTRUCTION CODE CURRENTLY IN EFFECT



LAURA WAKEFIELD
ARCHITECT
329 BROADWAY
DOBBS FERRY, NY 10522
TEL: 914 693 6165
N.Y.S STATE LICENSE
No. 27038

WARNING:
IT IS A VIOLATION OF THE NEW YORK STATE EDUCATIONAL LAW ARTICLE 148 SECTION 7209 FOR ANY PERSON UNLESS HE OR SHE IS ACTING UNDER THE DIRECTION OF A LICENSED PROFESSIONAL ARCHITECT, ENGINEER OR LAND SURVEYOR TO ALTER AN ITEM IN ANY WAY.

PROJECT TITLE:
GIGLIO PROPERTY
79 NORTH MOUNTAIN ROAD
DOBBS FERRY, N.Y. 10522
PROJECT NO.:

GOTHAM DESIGN
PLANNING AND
DEVELOPMENT LTD.

329 Broadway
Dobbs Ferry, N.Y. 10522
Phone: (914) 693-5093
Fax: (914) 693-5390
email: arch329@gmail.com

ISSUED / REVISIONS

SHEET TITLE:
SLOPE ANALYSIS

DATE: 06/15/2022	DRAWN BY: SSJ
SCALE: AS NOTED	CHECKED BY: PRS

A-1.1