



VILLAGE OF DOBBS FERRY
112 Main Street
Dobbs Ferry, New York 10522
TEL: (914) 231-8500 • FAX: (914) 693-3470

RECEIVED

APR 23 2021

Village of Dobbs Ferry
Building Department

Affidavit of Notice

STATE OF NEW YORK)
) ss.:
COUNTY OF WESTCHESTER)

I, Gregory Sharp, having been duly sworn, hereby deposes and says:

1. On 4-22-2021 I forwarded the notice attached as Exhibit 1 by Certified Mail to owners of properties within a 200' radius of the property located at:
11 Myrtle Ave, which is the subject of review for certain land use approvals in the Village of Dobbs Ferry; and
2. I have attached as Exhibit 2 the mailing list of the relevant property owners requested and received from the Town of Greenburgh Tax Assessor located at 177 Hillside Ave. White Plains, NY 10607, 914-989-1520, assessor@greenburghny.com; and
3. I have retained proof of these mailings and will make them available upon request or as otherwise required by the Village of Dobbs Ferry.

Dated: April 22, New York
_____, 2021

Signed: _____
Print name: Greg Sharp

Sworn to before me this
22 day of April, 2021

Roseanne Tenore
Notary Public

ROSEANNE TENORE
NOTARY PUBLIC-STATE OF NEW YORK

No. 01TE6138230

Qualified in Westchester County

My Commission Expires December 19, 2022



Gregory Sharp Architect, RA, AIA
145 Palisade St. Suit 211
Dobbs Ferry, NY 10522
917.597.1982

April, 22nd 2021



Certified Mail

Property is within 200' of the proposed project.

Dear Neighbor

This is a notification that the owner of the property located at:

11 Myrtle Avenue, Dobbs Ferry, NY 10522

Has filed an application with the Village of Dobbs Ferry to do the following:

Complete Renovation of the House at 11 Myrtle Avenue, Dobbs Ferry.

The applicant will present the proposal to the following Board at their next available meeting.

- ✓ Board of Trustees; meet 2nd & 4th Tuesday at 6:30PM
- ✓ Planning Board; meet 1st Thursday at 7:30PM
- ✓ **Zoning Board of Appeals, Wednesday May 12, 2021 at 8:00 PM**
- Architectural & Historic Review Board; meet 2nd & 4th Mondays at 8:00PM

During this pandemic crisis, our Statutory Board meetings will be conducted remotely. You will be able to participate via Zoom by internet or telephone, or you can watch the meeting livestream on YouTube. The videos can also be viewed after each meeting on YouTube and will be posted to our website.

For Public Hearings, we will accept emailed comments in advance of the hearing. Please email ldreaper@dobbsferry.com by 3pm the day before the hearing. For Zoom participants we will also enable the option for participants to "raise their hand" and voice their concern or question.

Owner name:

THE MUNITS RESIDENCE
Nathan and Margaret Munits



11 Myrtle Ave-200' Map-DF

Greenburgh, NY

1 inch = 120 Feet

0 120 240 360

CAI Technologies

Provides Mapped Assessments & Reports

January 6, 2021

RECEIVED
APR 23 2021
Village of Dobbs Ferry
Building Department

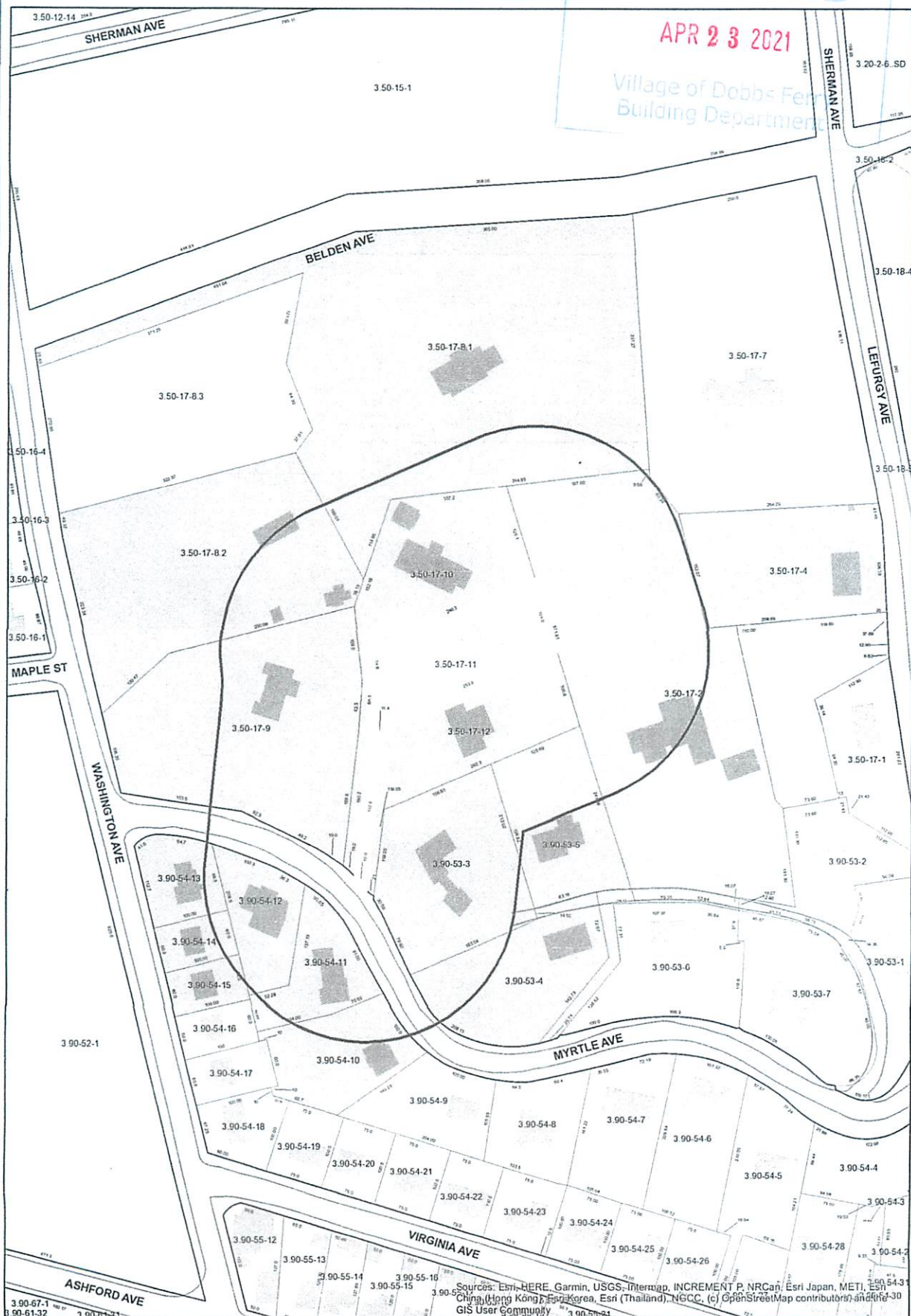

Data displayed on this map is for informational purposes only. Most layers originate from 3rd parties and cannot be verified by the Tax Assessor's office or CAI Technologies. Please consult with department or organization where data originates in order to verify accuracy. Any questions, call Town Assessor's Office: 1-914-989-1520.

| Parcel Number | GIS Number | Cama Number | Property Address | Owner Name | Co-Owner Name | Owner Address | Owner Address 2 | Owner City | Owner State | Owner Zip |
|---------------|-------------|-------------|-------------------|-------------------------|----------------------------|-------------------|-----------------|-------------|-------------|-----------|
| 3.50-17-10 | 3.50-17-10 | 3.50-17-10 | 7 MYRTLE AVE | HOLZMAN, LAURENCE | HOLZMAN, LARA | 7 MYRTLE AVE | | DOBBS FERRY | NY | 10522 |
| 3.50-17-12 | 3.50-17-12 | 3.50-17-12 | 15 MYRTLE AVE | KOURA, ANDREA | ANDREWS, THOMAS | 15 MYRTLE AVE | | DOBBS FERRY | NY | 10522 |
| 3.50-17-2.1 | 3.50-17-2.1 | 3.50-17-2.1 | 85 MYRTLE AVE | LAUDON, JESSE | LAUDON, LAURA P | 85 MYRTLE AVE | | DOBBS FERRY | NY | 10522 |
| 3.50-17-4 | 3.50-17-4 | 3.50-17-4 | 111 LEFURGY AVE | ROCK, EDYTHE N | ROCK, ERWIN H (DEC.) | 111 LEFURGY AVE | | DOBBS FERRY | NY | 10522 |
| 3.50-17-8.1 | 3.50-17-8.1 | 3.50-17-8.1 | 86 BELDEN AVE | CHILTON, ALEXANDER B. | CHILTON, LAURA H. | 86 BELDEN AVE | | DOBBS FERRY | NY | 10522 |
| 3.50-17-8.2 | 3.50-17-8.2 | 3.50-17-8.2 | 60 WASHINGTON AVE | KASARDA, SERGE | | 60 WASHINGTON AVE | | DOBBS FERRY | NY | 10522 |
| 3.50-17-9 | 3.50-17-9 | 3.50-17-9 | 1 MYRTLE AVE | OSTROW, ADAM | OSTROW, KENDALL | 1 MYRTLE AVE | | DOBBS FERRY | NY | 10522 |
| 3.90-53-3 | 3.90-53-3 | 3.90-53-3 | 35 MYRTLE AVE | QUINTERO, ALFREDO S. | CARNAHAN, SARAH | 35 MYRTLE AVE | | DOBBS FERRY | NY | 10522 |
| 3.90-53-4 | 3.90-53-4 | 3.90-53-4 | 45 MYRTLE AVE | JONES TRUST 1/2%, JAMES | JONES TRUST 1/2%, CHARLENE | 45 MYRTLE AVE | | DOBBS FERRY | NY | 10522 |
| 3.90-53-5 | 3.90-53-5 | 3.90-53-5 | 55 MYRTLE AVE | ANGER, HOWARD S | ANGER, ANDREA R | 55 MYRTLE AVE | | DOBBS FERRY | NY | 10522 |
| 3.90-54-10 | 3.90-54-10 | 3.90-54-10 | 30 MYRTLE AVE | HUNT, WILLIAM B. | RICE, ELIZABETH M. | 30 MYRTLE AVE | | DOBBS FERRY | NY | 10522 |
| 3.90-54-11 | 3.90-54-11 | 3.90-54-11 | 22 MYRTLE AVE | ECHANIQUE, JESSE | BERGER, NATALIE S | 22 MYRTLE AVE | | DOBBS FERRY | NY | 10522 |
| 3.90-54-12 | 3.90-54-12 | 3.90-54-12 | 12 MYRTLE AVE | SULLIVAN, JESSICA A | SULLIVAN, BRIAN | 12 MYRTLE AVE | | DOBBS FERRY | NY | 10522 |
| 3.90-54-13 | 3.90-54-13 | 3.90-54-13 | 40 WASHINGTON AVE | KEARNS, KRISTIN | | 40 WASHINGTON AVE | | DOBBS FERRY | NY | 10522 |
| 3.90-54-14 | 3.90-54-14 | 3.90-54-14 | 32 WASHINGTON AVE | MONTEMURRO, ROSARY | MONTEMURRO, ANTHONY | 32 WASHINGTON AVE | | DOBBS FERRY | NY | 10522 |
| 3.90-54-15 | 3.90-54-15 | 3.90-54-15 | 26 WASHINGTON AVE | CURY, SANDRA J | CURY, TOBIAS | 26 WASHINGTON AVE | | DOBBS FERRY | NY | 10522 |



DOBBS FERRY
120 MAIN ST
DOBBS FERRY, NY 10522-9998
(800)275-8777

04/22/2021 10:16 AM

| Product | Qty | Unit Price | Price |
|---------|-----|------------|-------|
|---------|-----|------------|-------|

| | | | |
|----------------|----|--------|--------|
| Uncle Sams Hat | 16 | \$0.20 | \$3.20 |
|----------------|----|--------|--------|

| | | | |
|--------------------|----|--------|---------|
| \$2 Statue Freedom | 42 | \$2.00 | \$84.00 |
|--------------------|----|--------|---------|

Grand Total: \$87.20

Credit Card Remitted \$87.20

Card Name: VISA
Account #: XXXXXXXXXXXX1157
Approval #: 06742C
Transaction #: 307
AID: A0000000031010 Chip
AL: VISA CREDIT
PIN: Not Required CHASE VISA

USPS is experiencing unprecedented volume
increases and limited employee
availability due to the impacts of
COVID-19. We appreciate your patience.

Preview your Mail
Track your Packages
Sign up for FREE @
<https://informedelivery.usps.com>

Earn rewards on your business account
purchases of Priority Mail labels
with the USPS Loyalty program by
using Click and Ship. Visit
www.usps.com/smallbizloyalty
for more info.

All sales final on stamps and postage.
Refunds for guaranteed services only.
Thank you for your business.

Tell us about your experience.
Go to: <https://postalexperience.com/Pos>
or scan this code with your mobile device.



or call 1-800-410-7420.

UFN: 352250-0030
Receipt #: 840-51050020-1-3152823-2
Clerk: 1