



VILLAGE OF DOBBS FERRY BOARD OF TRUSTEES AGENDA

MEETING DATE: AUGUST 11, 2020
AGENDA ITEM SECTION: MATTERS REQUIRING ACTION
AGENDA ITEM NO. : 14
AGENDA ITEM: CONSIDER A MOTION TO APPROVE A REQUEST FROM THE VILLAGE CLERK/2020 CENSUS LIAISON TO REVIEW LOCATION, PLACEMENT AND NUMBER OF SIGNS FOR 2020 CENSUS ON VILLAGE PROPERTY
ITEM BACKUP DOCUMENTATION: <ol style="list-style-type: none">1. MEMORANDUM AND ATTACHMENTS DATED JULY 30, 2020 FROM MS. ELIZABETH DREAPER, RMC/VILLAGE CLERK & 2020 CENSUS LIAISON TO MAYOR VINCENT ROSSILLO AND THE BOARD OF TRUSTEES



**VILLAGE OF DOBBS FERRY
OFFICE OF THE VILLAGE CLERK**

112 Main Street
Dobbs Ferry, New York 10522
TEL: (914) 231-8504 • FAX: (914) 693-3470

Memorandum

To: Mayor Vincent Rossillo and Village Board of Trustees

Cc: Mr. Edmond Manley/Acting Village Administrator
Ms. Lori Lee Dickson/Attorney for the Village

From: Elizabeth Dreaper RMC, Village Clerk & 2020 Census Liaison

Subject: 2020 Census Signage

Date: July 30, 2020

The Westchester County Census Coordinator delivered sixty (60), 2020 Census lawn signs to my office.

I am requesting for the Board's approval for placement of thirty (30) of the signs at various Village owned property/locations from now through the end of the 2020 Census campaign on October 31, 2020; and for thirty (30) signs to be reserved for placement on private property within the Village of Dobbs Ferry as requested by the property owner on a first come, first serve basis.

The measurement of the sign is 18" x 24". I have attached a copy of the sign as well as pictures detailing the proposed location of each of the 30 signs that would be placed on Village owned property/locations.

Please contact me if you have any questions.

Thank you for your consideration of this request.

YOU COUNT

fill out the census at
my2020census.gov



ASHFORD AVENUE ISLAND



②

①

LIVINGSTON/BROADWAY ISLAND



4

3



LANGDON/BROADWAY

GOULD PARK: MAPLE/WASHINGTON



GOULD PARK: MARLE/DEVOL ENTRANCE



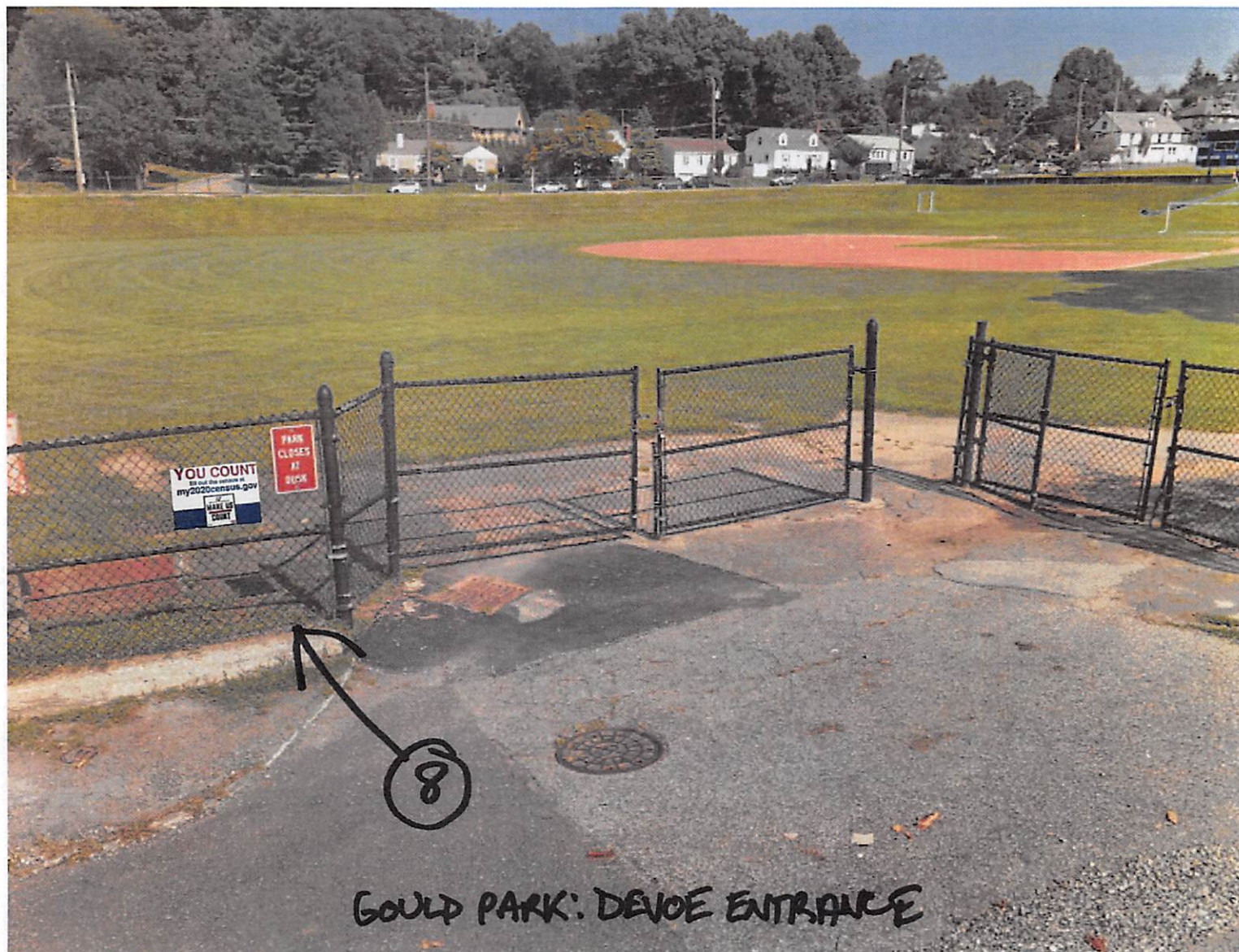

GOULD PARK: DEVOE ENTRANCE



GOULD PARK FENCE: ASHFORD/BEACON HILL DR.

COULD PARK FENCE: ASHFORD / WASHINGTON



GOULD PARK FENCE: WASHINGTON ENTRANCE





CORNER OF CEDAR/MAIN

12

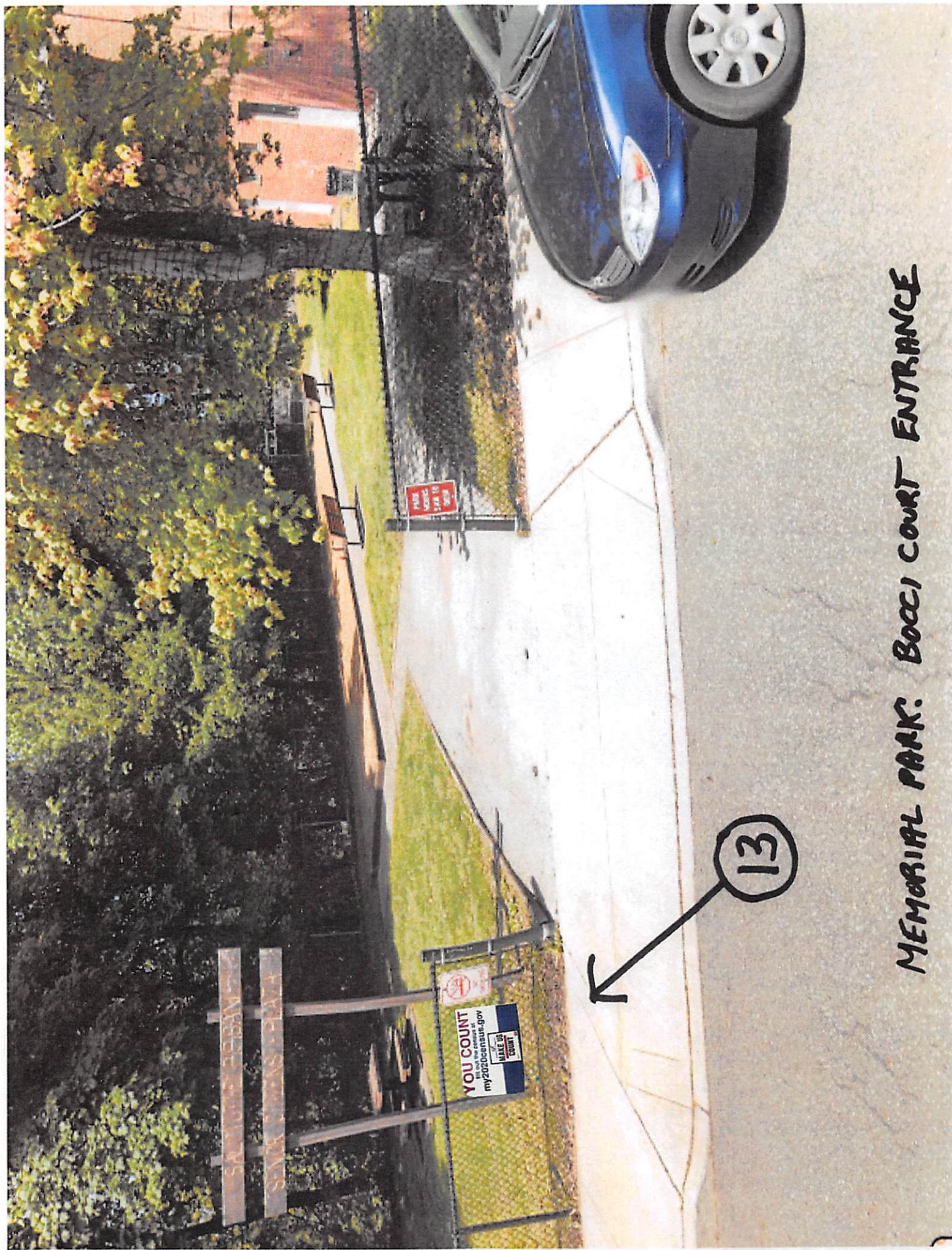

MEMORIAL PARK: BOCCI COURT ENTRANCE

MEMORIAL PARK ENTRANCE

PARK
HOURS
5AM TO
DUSK

YOU COUNT
the census at
my2020census.gov
MAKE US
COUNT

K14

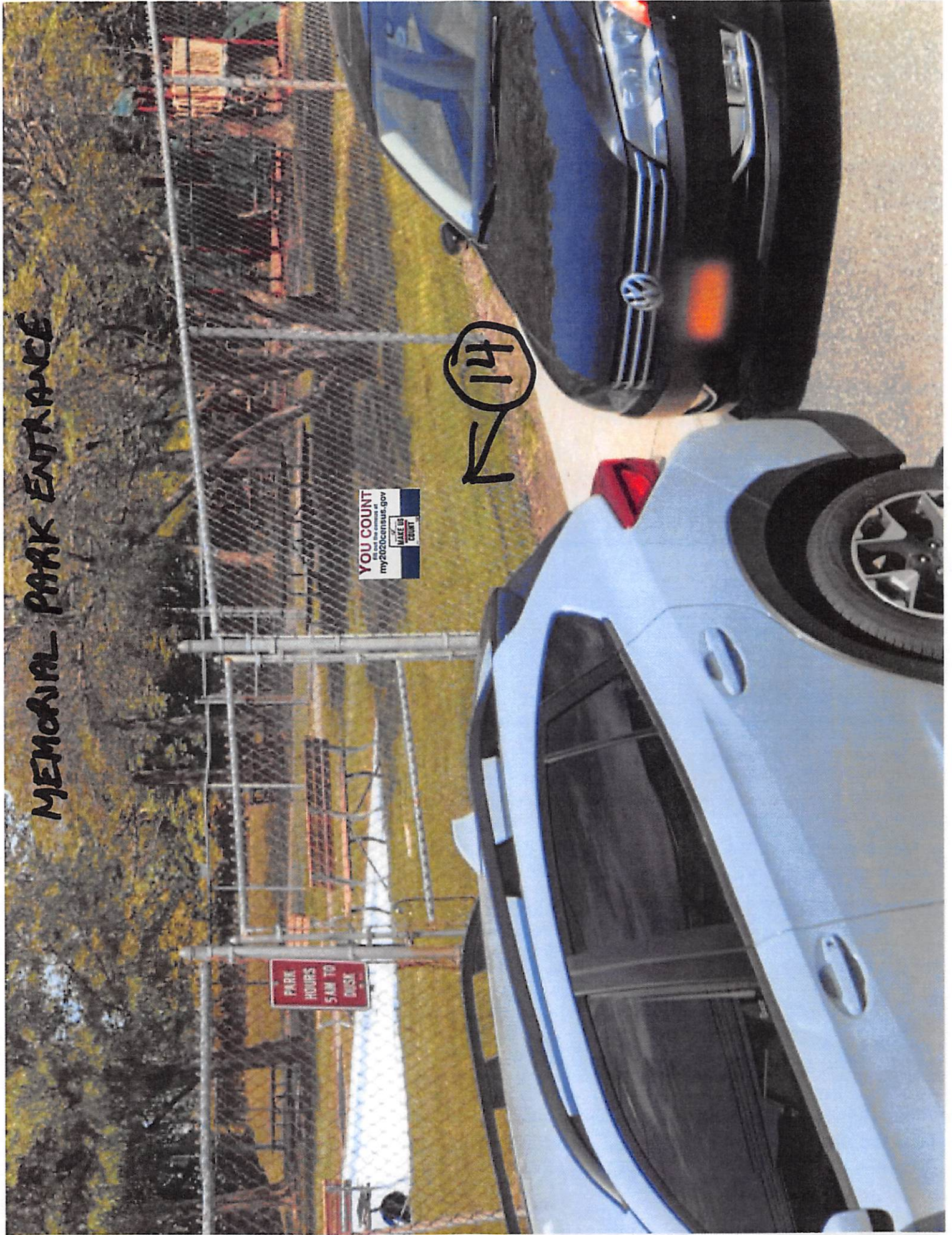

MEMORIAL PARK FENCE

15

YOU COUNT
my2020census.gov
MAKE UP
COUNT

REGISTER ONLINE NOW
MEMORIAL PARK
BIRMINGHAM

NO PARKING
ANYTIME
FIRE DEPT
FIRE DEPT

PALISADE ST



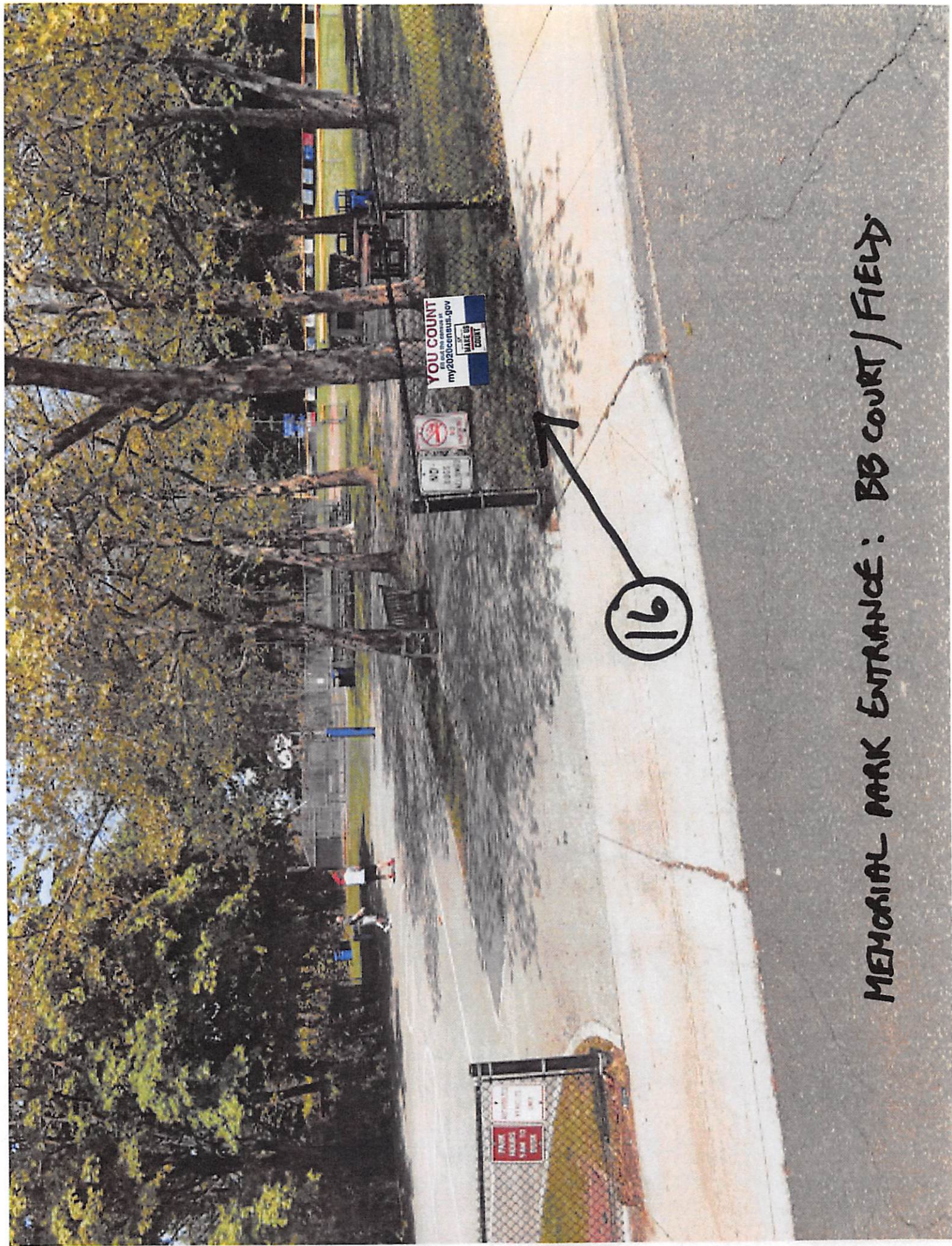

MEMORIAL PARK ENTRANCE: BB COURT / FIELD

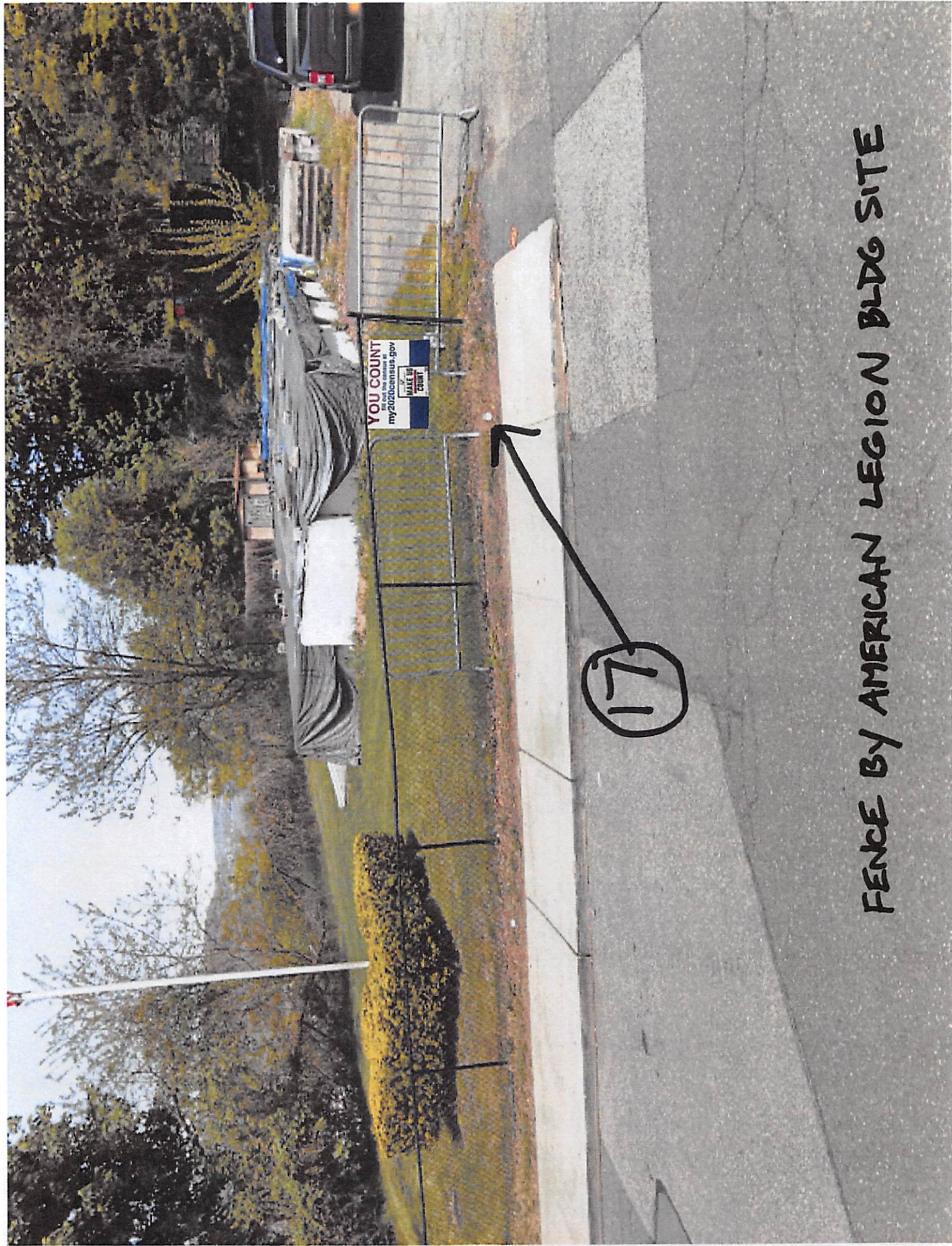

FENCE BY AMERICAN LEGION BLDG SITE

WF PARK



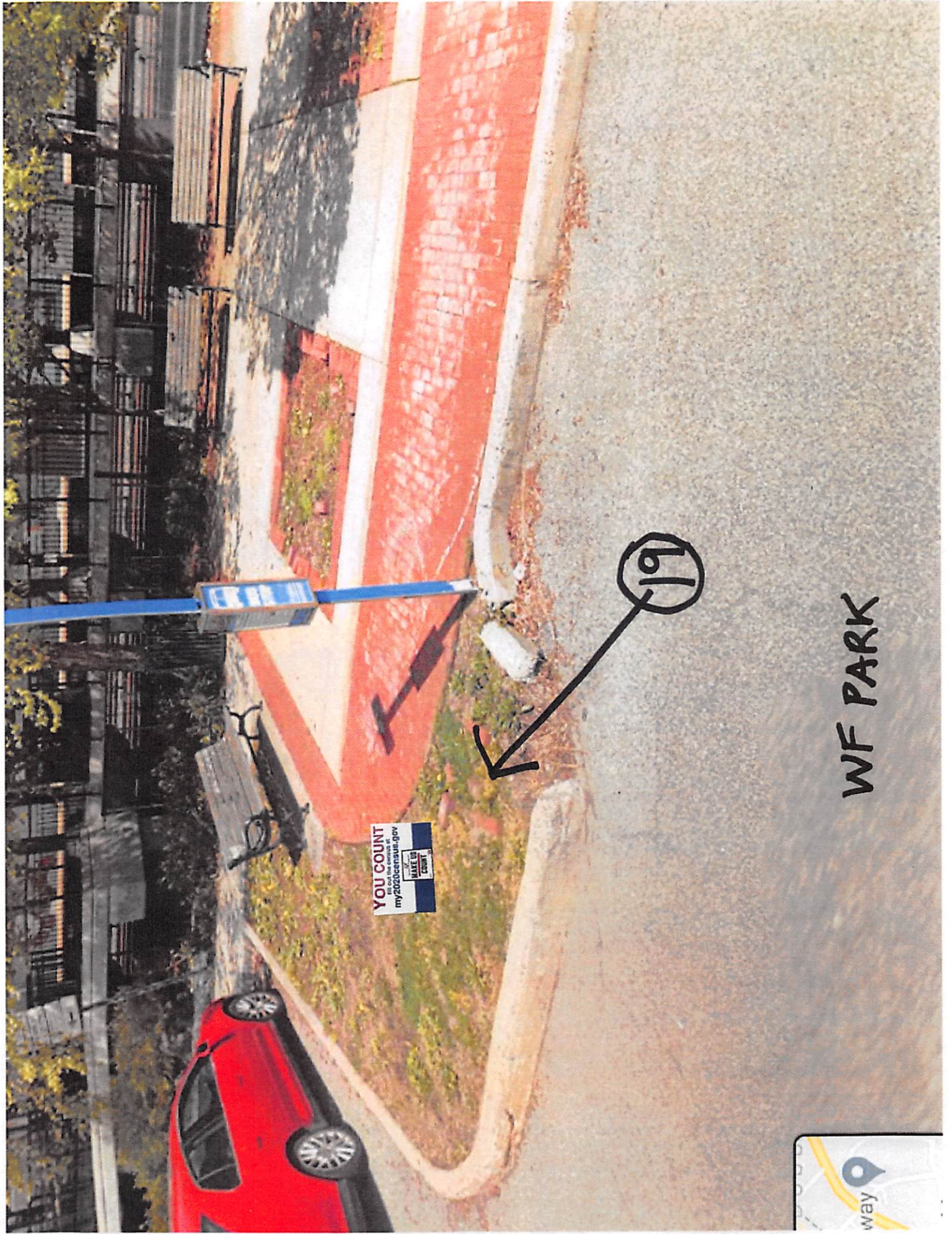

WF PARK

191

YOU COUNT
fill out the census at
my2020census.gov
DATE
COUNT

WF PARK





WF PARK



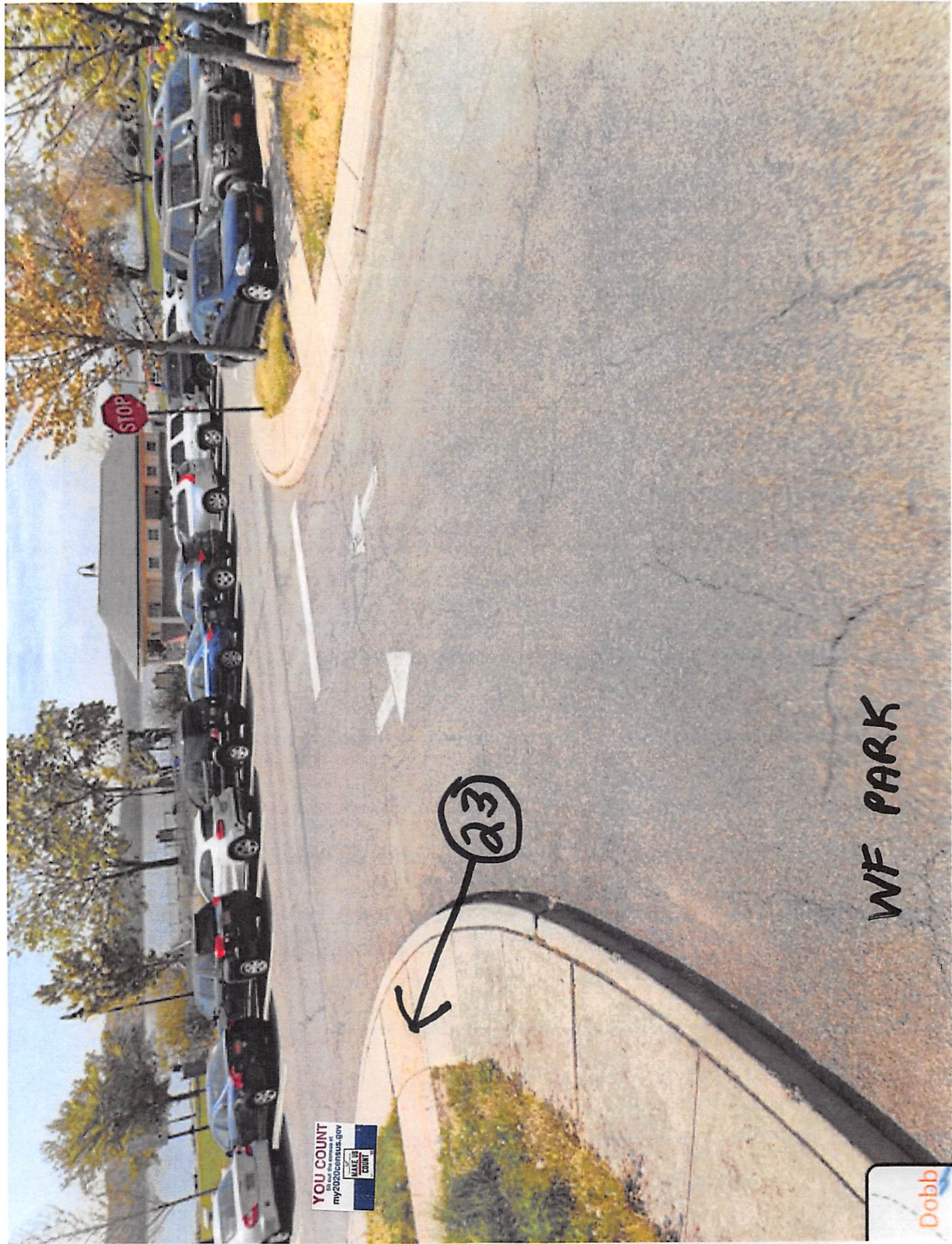

YOU COUNT
the address at
my2020census.gov
MAKE US
COUNT

WF PARK

Dobb



TRAIN STATION PLAZA



TRAIN STATION PLAZA

25



TRAIN STATION PLAZA



VILLAGE HALL PARKING LOT ENTRANCE

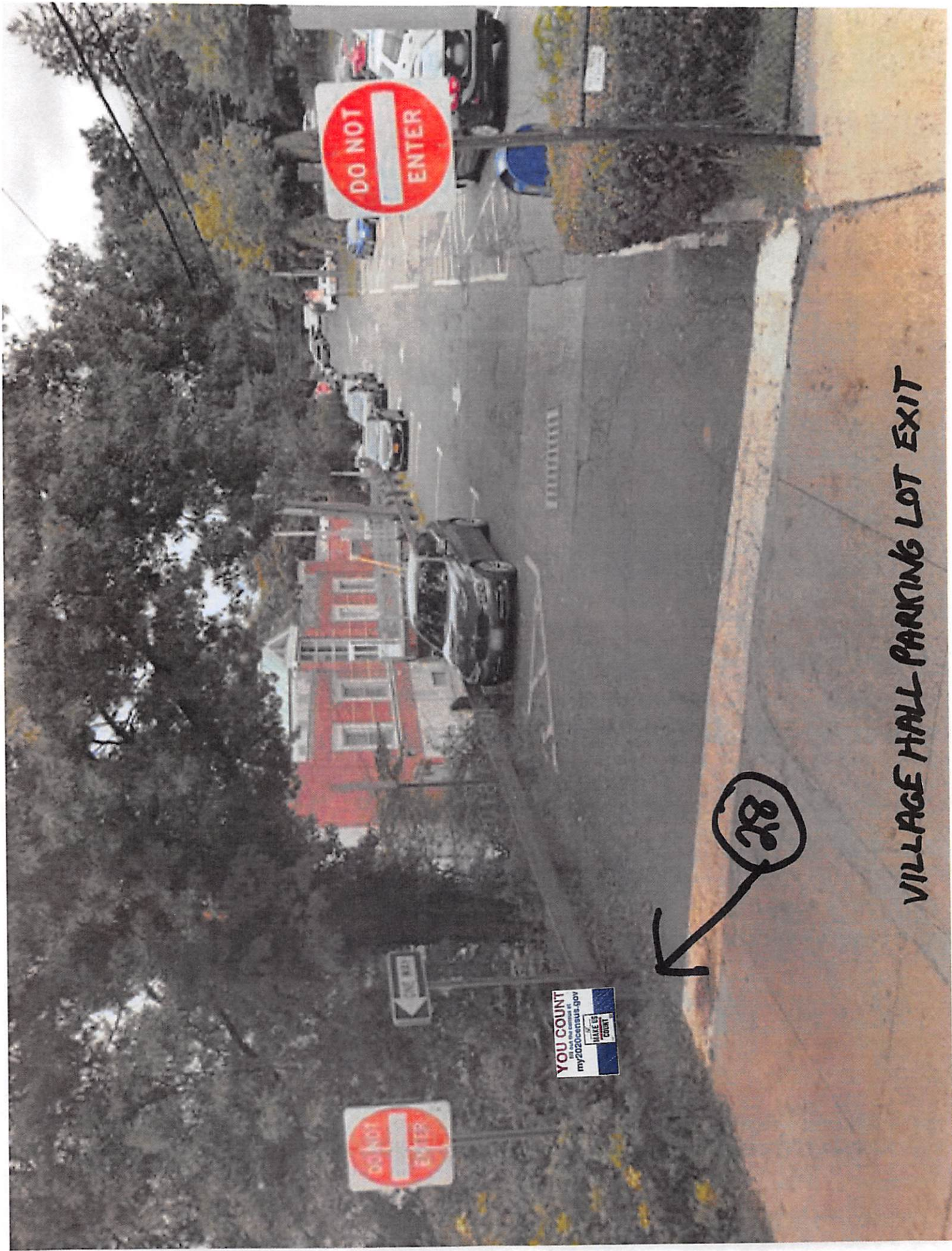

VILLAGE HALL PARKING LOT EXIT

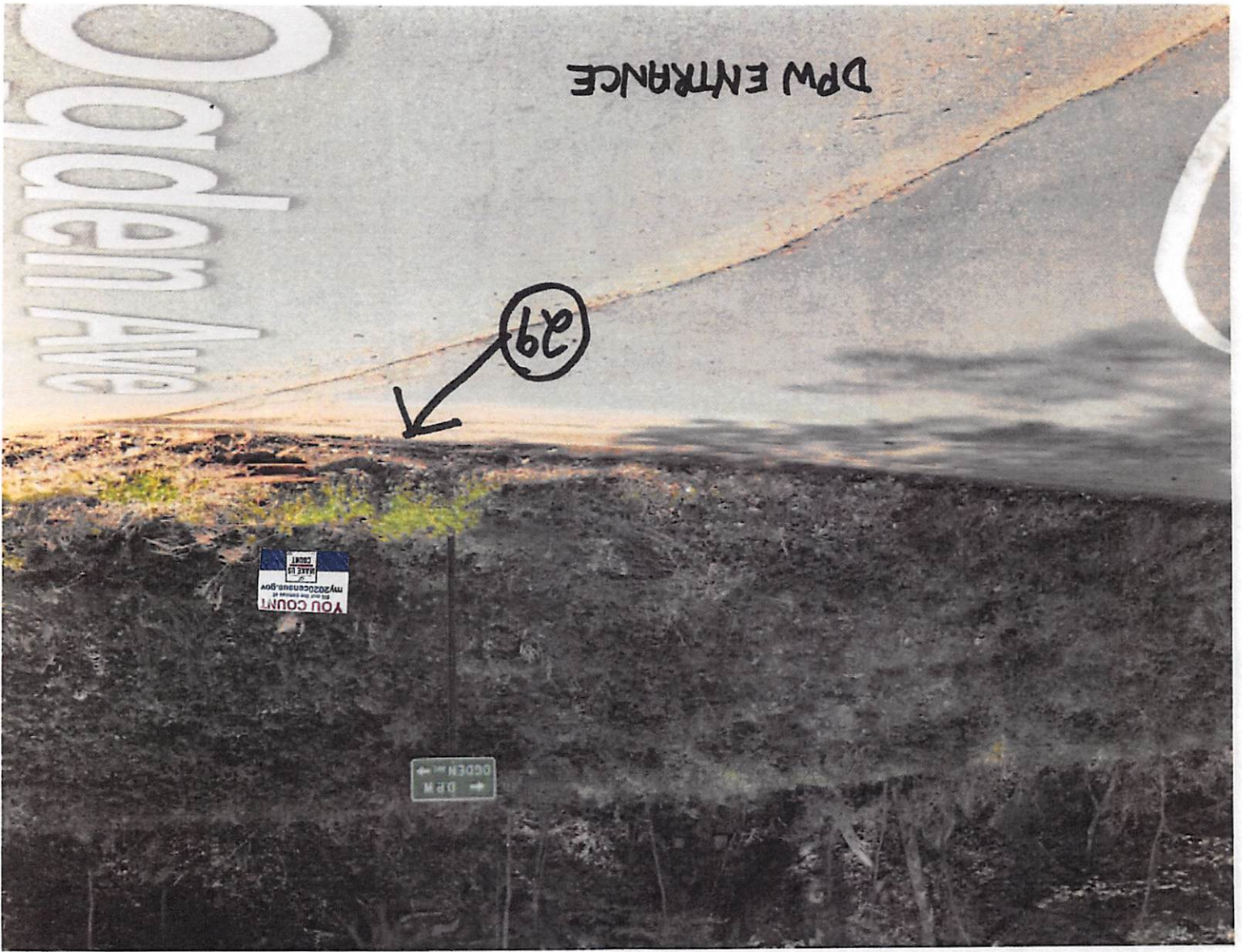

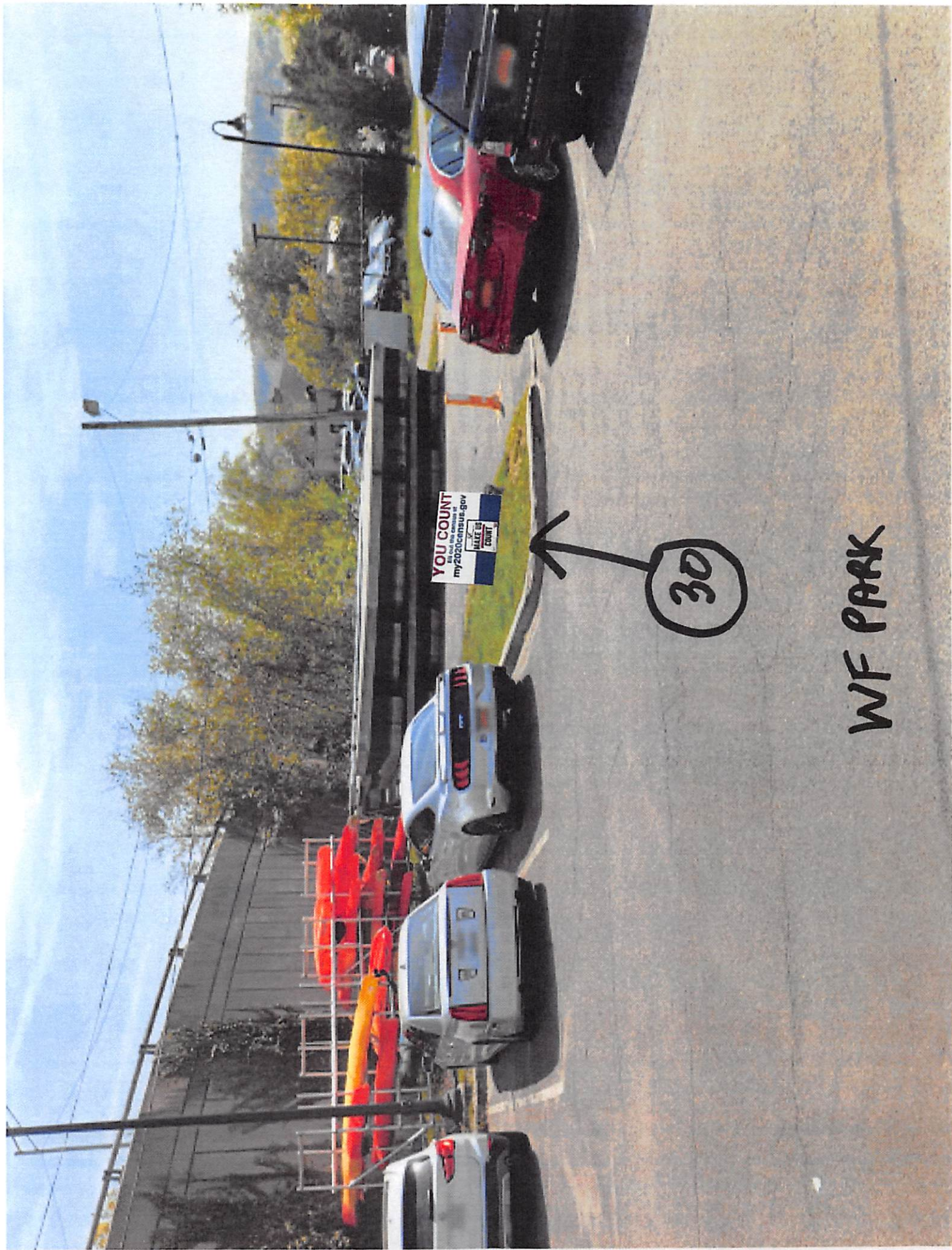

WF PARK